

# PETKIT™

## USER MANUAL

PETKIT YUMSHARE SOLO 2 WITH CAMERA  
SMART PET FEEDER

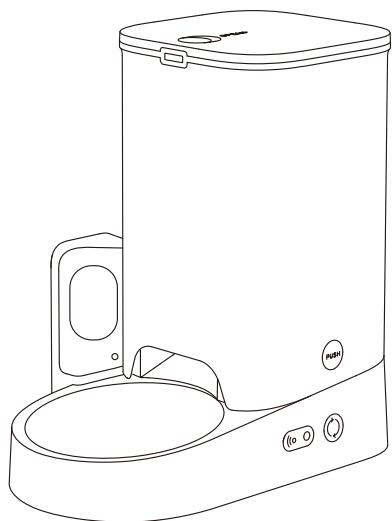

Please read the user manual carefully before using the product and keep it properly for future reference.

# TABLE OF CONTENTS

<b>PACKAGE LIST</b> .....	<b>3</b>
<b>PRODUCT DESCRIPTION</b> .....	<b>4</b>
<b>INSTALLATION GUIDE</b> .....	<b>6</b>
<b>USAGE GUIDE</b> .....	<b>9</b>
<b>DESCRIPTION OF APP FUNCTIONS</b> .....	<b>14</b>
<b>CLEANING AND MAINTENANCE</b> .....	<b>26</b>
<b>VIDEO GUIDE</b> .....	<b>28</b>
<b>BASIC SPECIFICATIONS</b> .....	<b>28</b>
<b>TO OUR VALUED USERS</b> .....	<b>29</b>
<b>SAFETY INSTRUCTIONS</b> .....	<b>29</b>

# 01 PACKAGE LIST

\* Please confirm that the following accessories are complete before installation and use.  
(Batteries or screwdrivers are not equipped and need to be purchased separately)

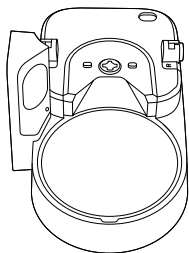

**Main Unit**

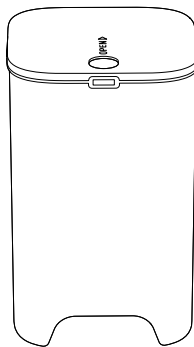

**Hopper**

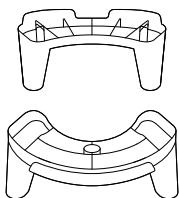

**Elevated Stand**

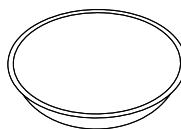

**Food Bowl**

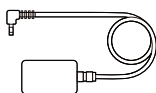

**Adapter**

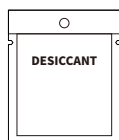

**Desiccant**



**User Manual**

\*Due to continuous product improvements, there may be slight differences in the actual product (including but not limited to appearance, structure, and color). The product images displayed on packaging and promotional materials are for reference only.

# 02 PRODUCT DESCRIPTION

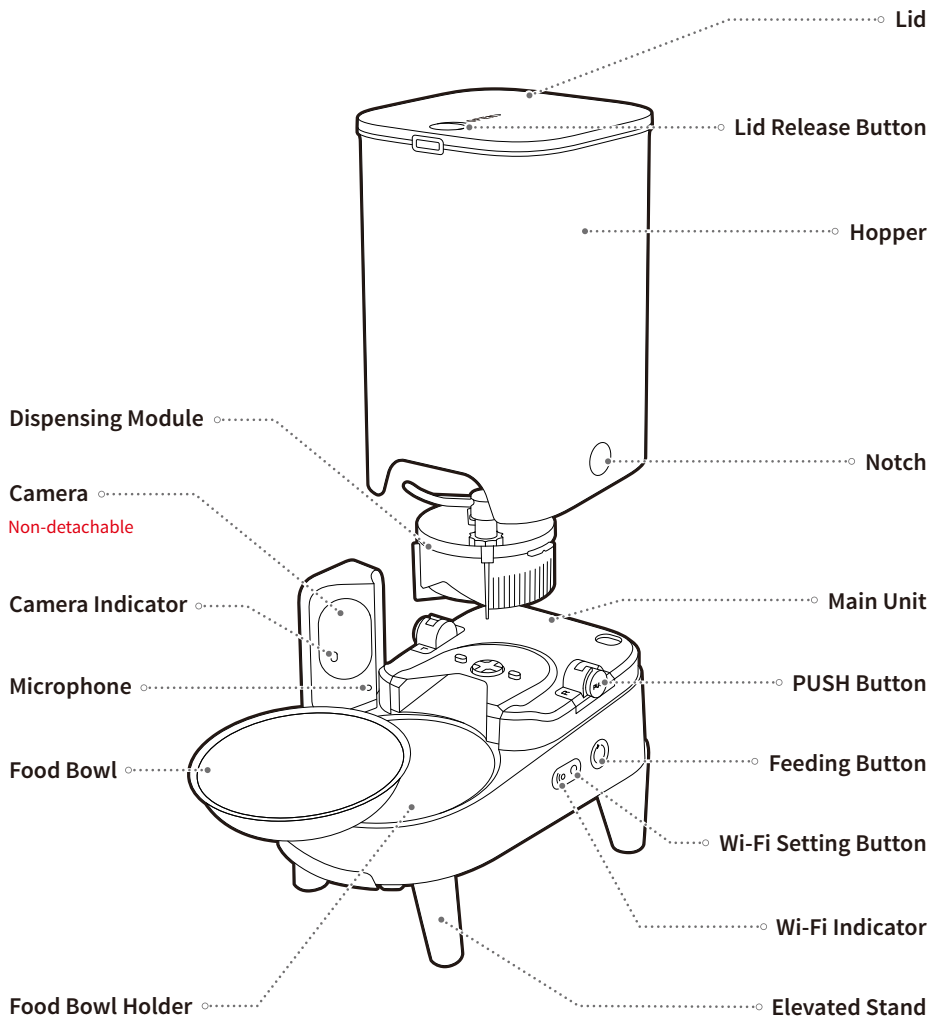

**Back of the main unit**

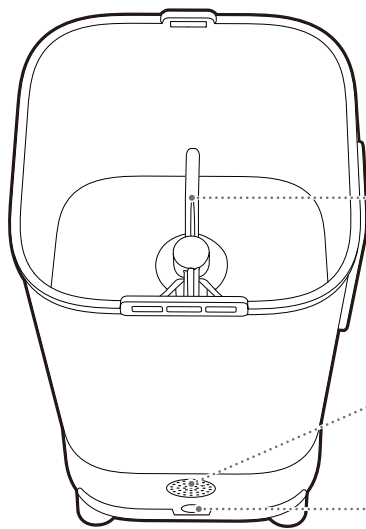

Food Dispensing  
Vanes

Speaker

Power Port

**Interior of  
the lid**

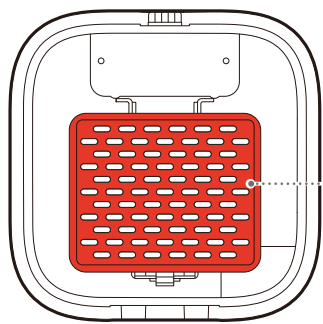

Desiccant  
Compartment

# 03 INSTALLATION GUIDE

## 3.1 Installing the Main Unit

❶ Place the main unit on the level ground or desk.

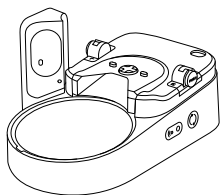

❷ Lift the hopper, align the notches on both sides with the PUSH button on the main unit, and place it vertically downwards.

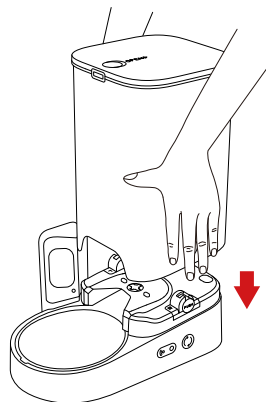

❸ Press and hold the PUSH buttons until they are fully stuck into the notches.

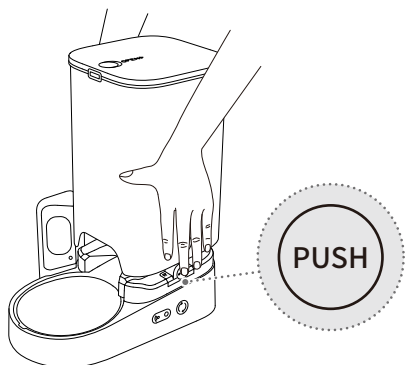

❹ Turn the feeder upside down. Remove the two rear anti-slip pads. Insert the elevated stand marked "BACK" into the rear slots of the feeder.

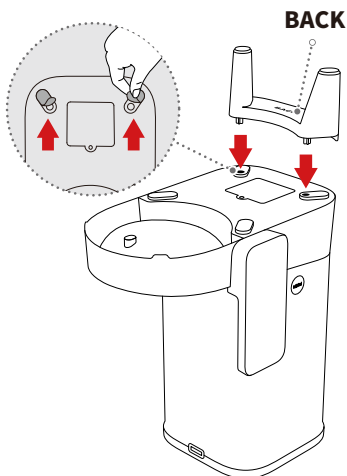

⑤ Align the elevated stand marked “FRONT” with the round buckle at the front bottom, then press downward until it clicks into place.

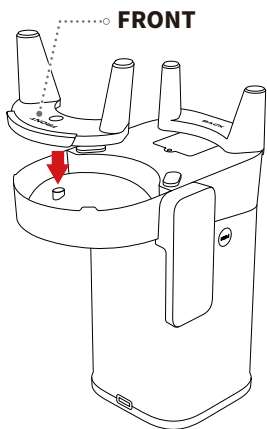

⑥ After installation, turn the feeder upright and place it on a flat surface. Ensure the elevated stands are securely attached, then install the food bowl.

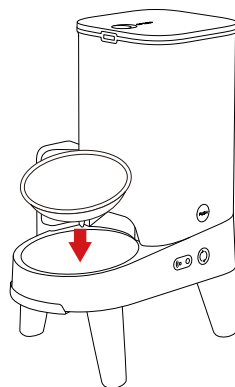

### 3.2 Connecting to the Power Supply

Take out the power adapter and insert it into the power port, then connect it to the power supply.

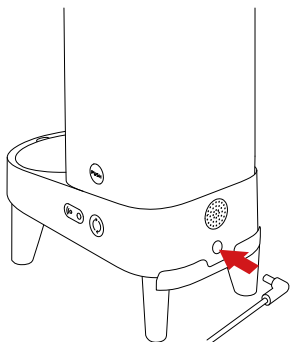

### 3.3 Installing Batteries

**!** Depending on your usage needs, you may choose to install batteries. If needed, install the batteries before attaching the elevated stands. (Please purchase batteries separately. Only alkaline batteries are supported.)

- ① Unscrew the screw and remove the battery cover.
- ② Install five AAA alkaline batteries (pay attention to the orientation).
- ③ Install the battery cover and tighten the screws.

**!** Note: Replace promptly when low on power. If away for long, check and replace with new ones.

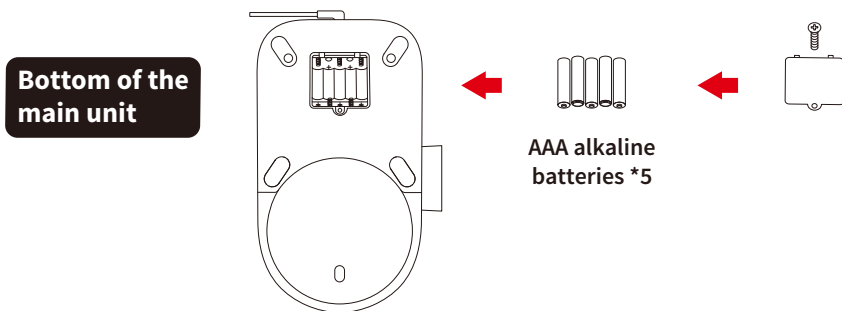

### 3.4 Installing the Desiccant

① Press the lid release button to the right as shown in the picture, and lift it up to remove the lid.

② Open the desiccant compartment, put the desiccant in it, and close the desiccant compartment.

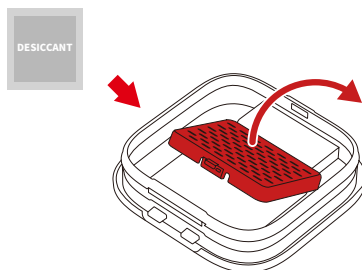
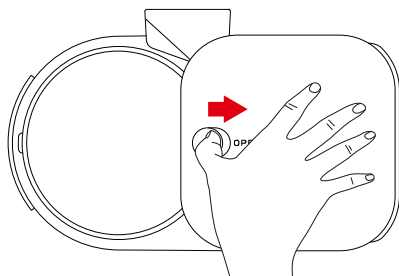

# 04 USAGE GUIDE

## 4.1 Adding Pet Food

❶ Remove the lid and add pet food. Do not exceed the MAX line.

\* Recommended kibble size:  $\leq 12\text{mm}$  (0.47in)

Recommended freeze-dried food size:  $\leq 9\text{mm}$  (0.35in)

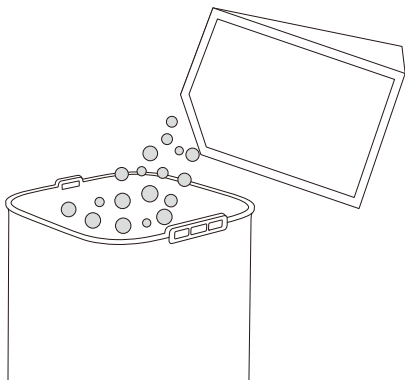

❷ Install the lid: Insert the rear side of the lid into the two holes above the hopper, then press down on the lid.

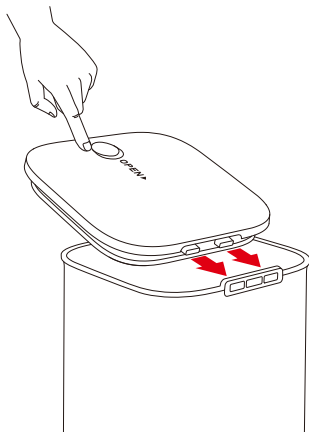

## 4.2 Indicator Light

<b>Wi-Fi Indicator</b>	Slow flashing white	Fast flashing white	Solid white
<b>Status</b>	Device is not connected to Wi-Fi	Device is connecting to Wi-Fi	Device is connected to Wi-Fi

The camera indicator can be turned on or turned off in the PETKIT App. In battery mode, the camera indicator is off.

<b>Camera Indicator</b>	Solid green	Light off
<b>Status</b>	Camera is turned on	Camera is turned off

**Camera Indicator**

**Wi-Fi Indicator**

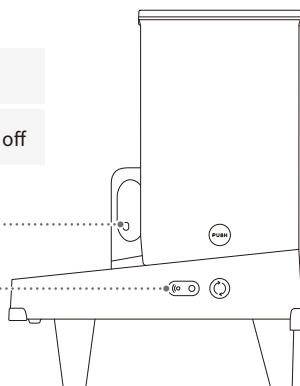

## 4.3 Manual Feeding

Press and hold the button to dispense food. Release it to stop dispensing.

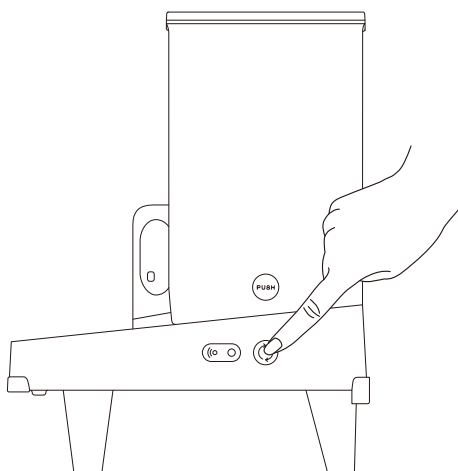

## 4.4 App Binding and Activation

① Download and install the PETKIT App:

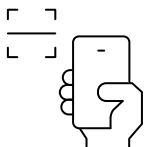

Download the PETKIT App in an App Store  
or Android Stores

② Add a device

Open the PETKIT App and enter its homepage; click “+” on the top right corner of the page to select and add the “PETKIT YUMSHARE SOLO 2 WITH CAMERA SMART PET FEEDER”.

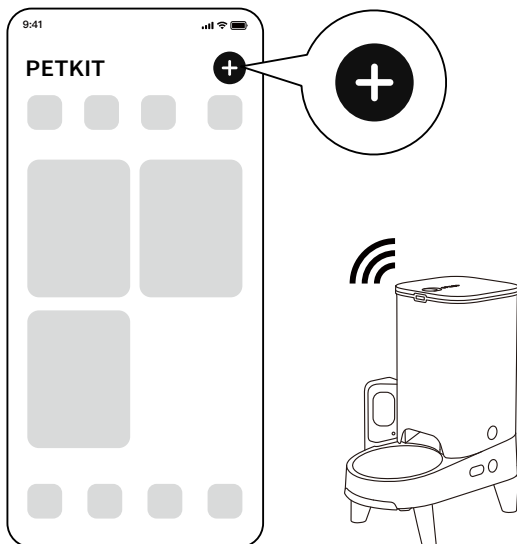

### 3 Start connection

In the startup state, long press the Wi-Fi setup button for 5 seconds until the indicator light on the device flashes rapidly; click Next to configure Wi-Fi and the App will start to connect to the device. Please wait until the App displays configuration succeeds.

\* This device supports 5GHz Wi-Fi connection.

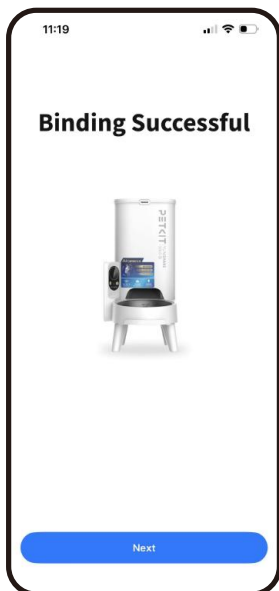
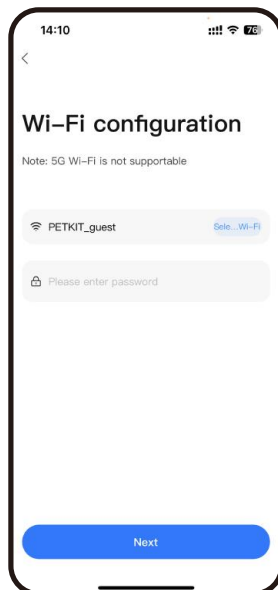

#### 4 Read usage guidelines

After the device successfully connects to the PETKIT App for the first time, to ensure pet safety and proper use of the product, please carefully read the usage guidelines and appropriately use the product according to the instructions.

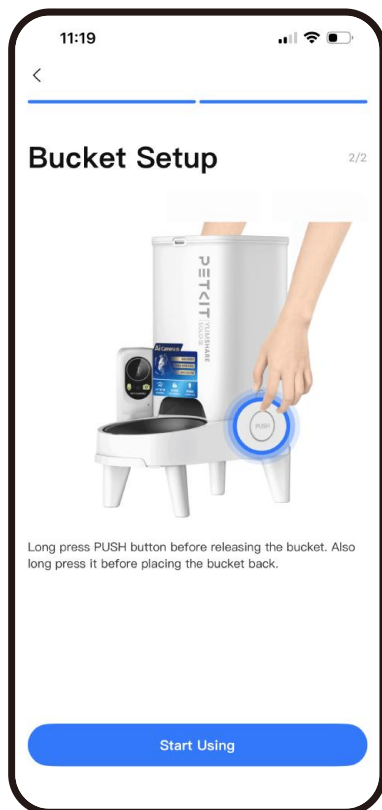

# 05 DESCRIPTION OF APP FUNCTIONS

## 5.1 Device Homepage

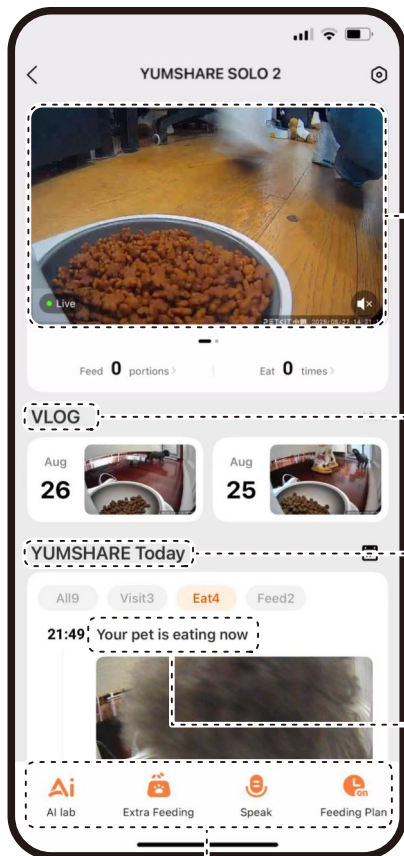

**1 Live View**

View your pet's status in real-time.

**2 VLOG**

Click **Make**, and the system will automatically generate vlogs of your pet. This section displays up to the last 7 days of video.

**3 YUMSHARE today (Timeline)**

Clips captured are categorized as visit, eat and feed through AI algorithm. You can click any of them for more details.

*\* Only pictures can be viewed when PETKIT Care+ Cloud Service is not subscribed. Please subscribe the Service if you want such functions as playing back full clips, moments and speedup playback. For specific rules, please refer to PETKIT Care+ Service Agreement.*

**4 Pet Matching:**

Click the event name to manually match the corresponding pet to it.

**5 Function keys**

5 Description of function keys



Extra feeding

Click it to dispense food for your pets instantly.  
(Remote control is supported.)

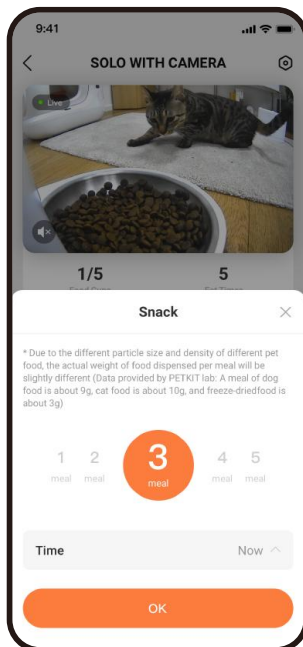

Speak

Long press “Speak”, and the feeder will broadcast what you said simultaneously, so as to have dialogues with your pets in real time.

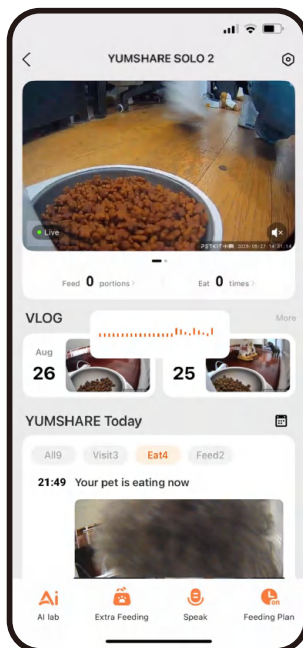

\* The interface may be different due to software version update; the actual interface shall prevail.



## Feeding plans

Set up the feeding time and portions to make sure your pet is feed on time.

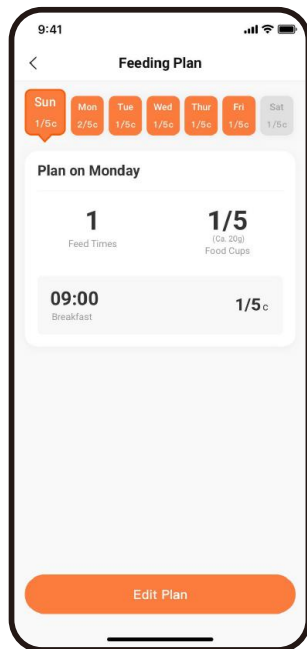

## 5.2 Three Ways to Play Videos

After subscribing the PETKIT Care+ Cloud Service, click the Timeline on the homepage of the device to play back full clips, highlight with speedup options.

### ① Highlight playback

You can preview 4-second videos that are sped up by clicking them in the Timeline.

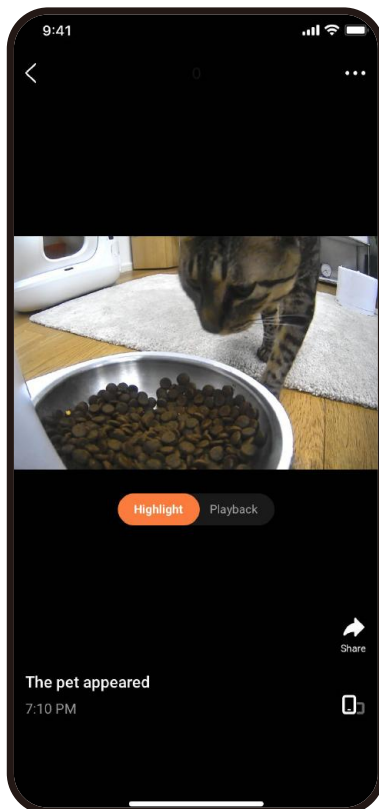
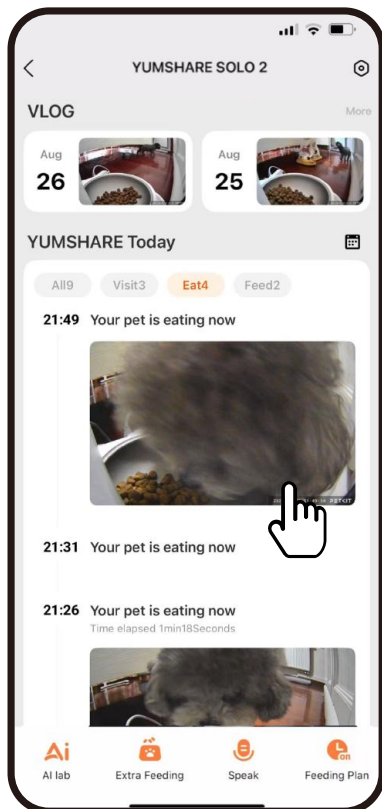

## ② Full clips playback

Switch the tag to “Playback” to watch complete video clips.

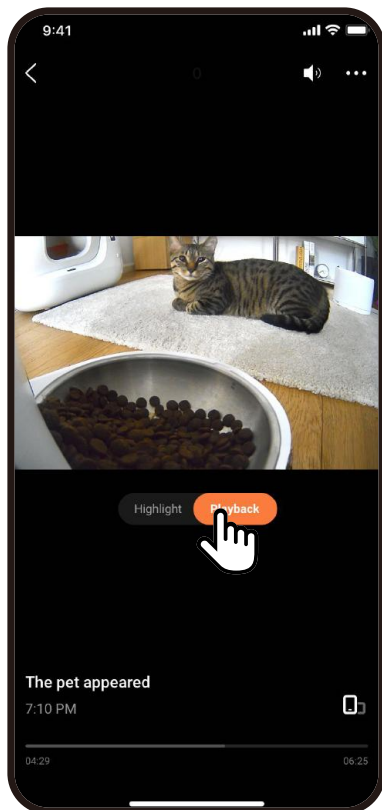

### 3 Speedup playback

When playing full video clips, click “...” on the top right corner to choose the speed as needed, or long press the center of video frame to directly switch to 2x play.

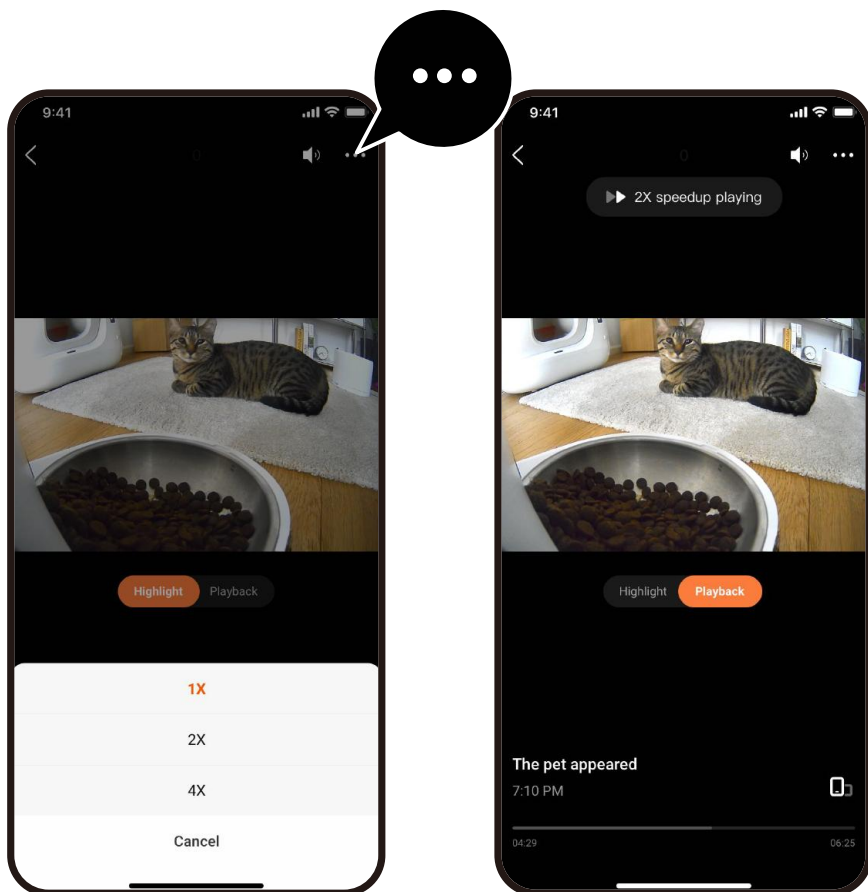

## 5.3 Delete Video Clips

You are entitled to delete any video.

### ① Method 1:

Delete videos in the Timeline;

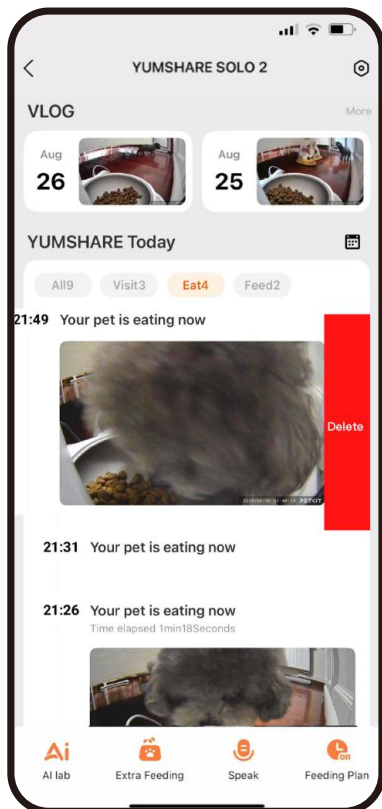

### ② Method 2:

Delete videos in VLOG. Click the video you want to remove, turn its play tag to "Full" and click the "... " on the top right corner to delete the video.

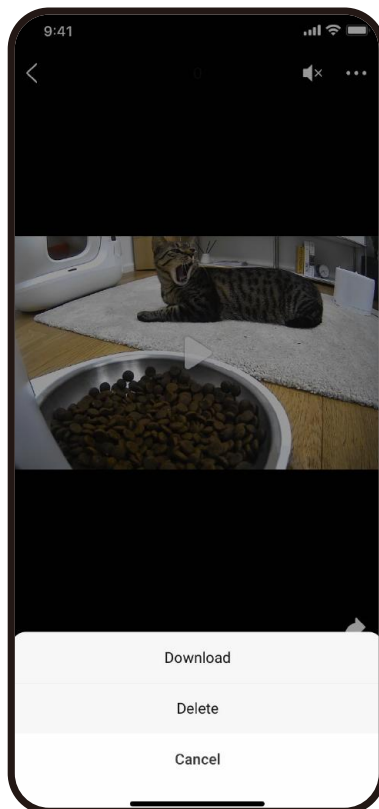

## 5.4 Privacy Protection

① Camera permissions: You are entitled to turn the camera on or off as needed.

⚠️ If it is turned off, any video footage fails to be captured.

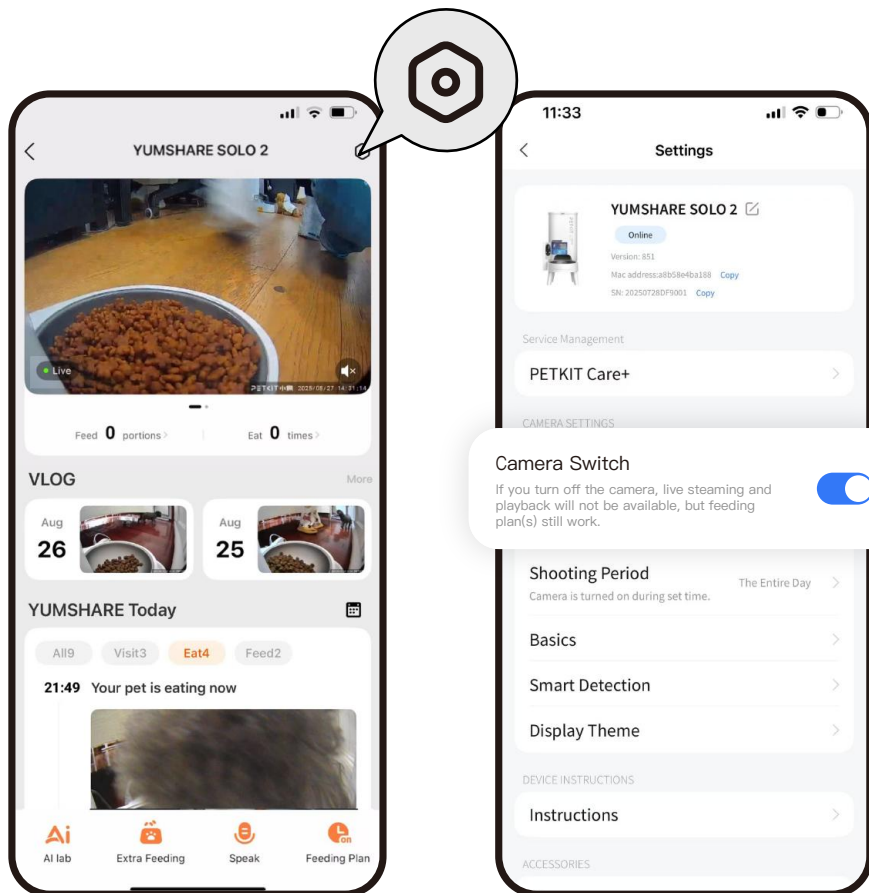

\* The interface may be different due to software version update; the actual interface shall prevail.

## Customize the detection time periods of the camera

You can personalize the time slots to turn on the camera, and beyond those, the camera is turned off automatically.

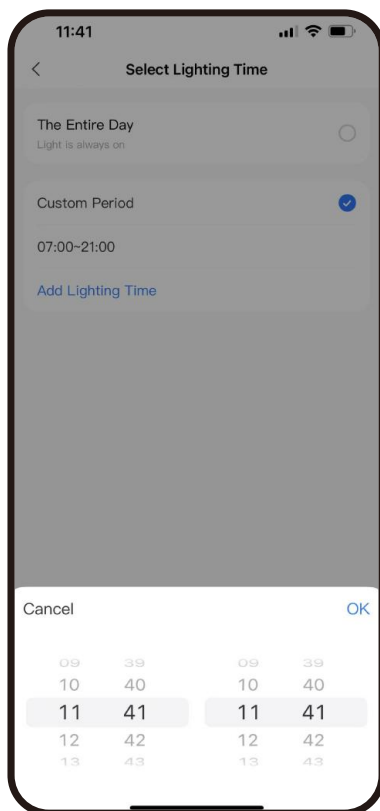
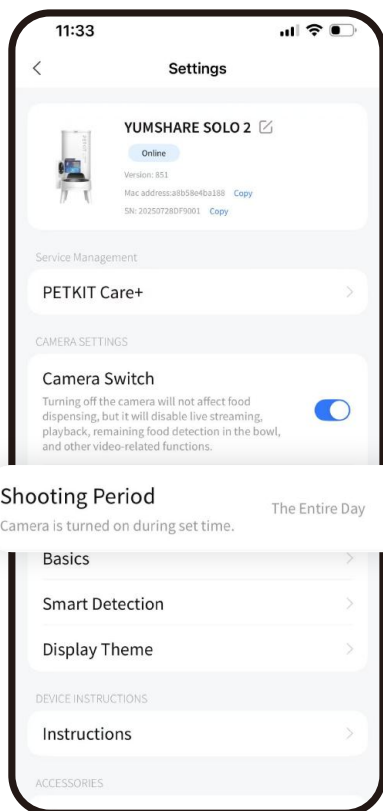

## ② Microphone permissions

You are entitled to turn on or off the microphone as needed.

⚠️ If it is turned off, there is no sound for any video footage.

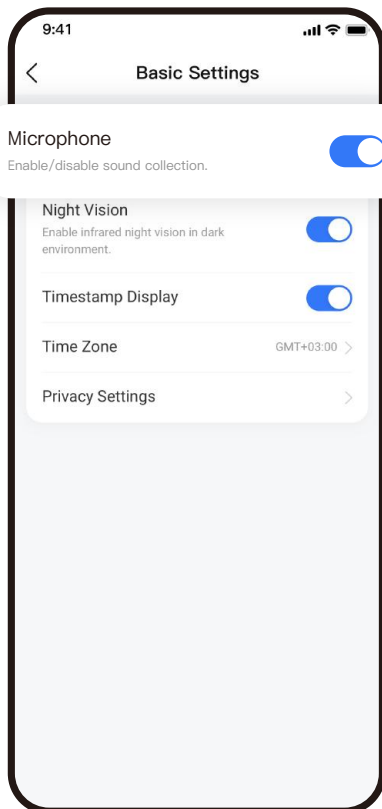
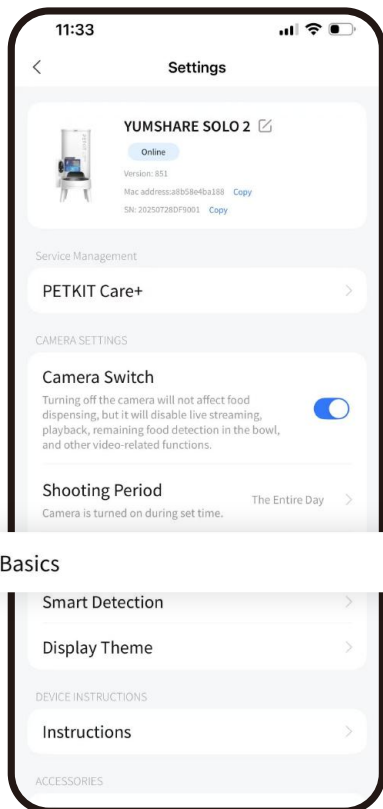

### 3 Live view privacy protection

After this feature is enabled, the live view will appear blurred on the device homepage to protect your privacy.

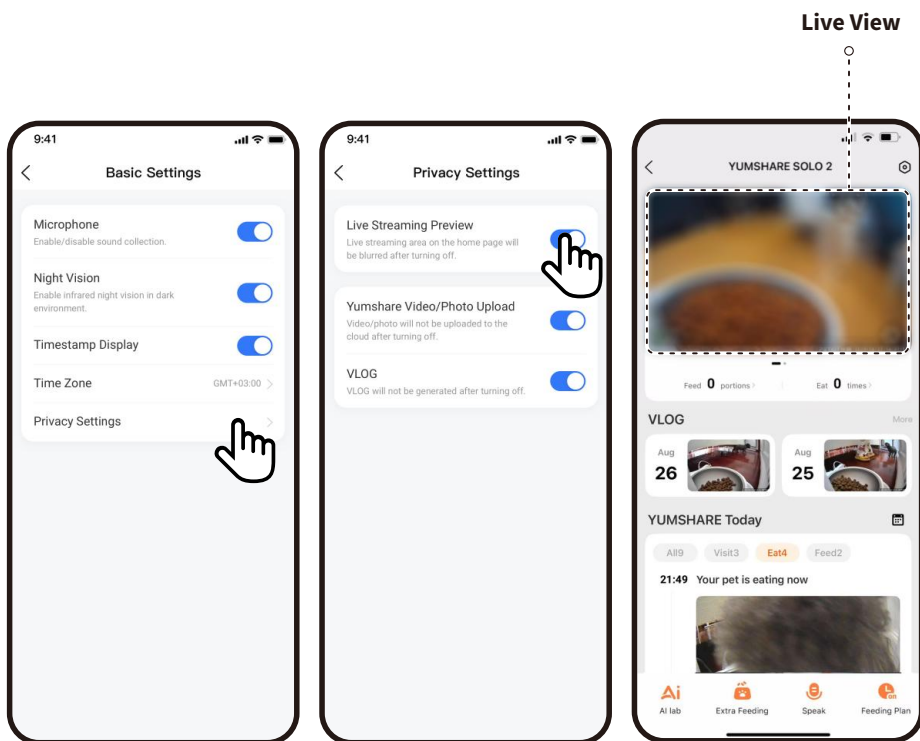

## 5.5 Additional Notes

### ① Cyclic videos stored in the Cloud

The playback contents are based on time-limited cyclic storage, and the data outside the time limit is periodically cleared. All videos can be downloaded and viewed in your phone's local and App albums. (e.g. 7-day video loop means that the videos or pictures stored in the last 7 days will be retained except for today's and meanwhile the contents of the day before the last 7 days will be automatically cleared.)

### ② PETKIT Care+ Cloud Service

You can purchase the Service for every feeder with camera via the App to enjoy such services as pet detection, playing back full HD video stored in the Cloud and HD Moments, which are subject to actual description. Multiple purchases of the Service are supported. PETKIT staff will provide you service upgrade or extension according to the attributes of the service you have bought. The Cloud Service is allowed to be transferred to another device for once a year. Please note that the Cloud Service is a virtual product so that it is not refundable once purchased.



Click to check items of PETKIT Care+ Cloud Service Agreement.

# 06 CLEANING AND MAINTENANCE

① Open the lid, remove the used desiccant, and remove the bowl.

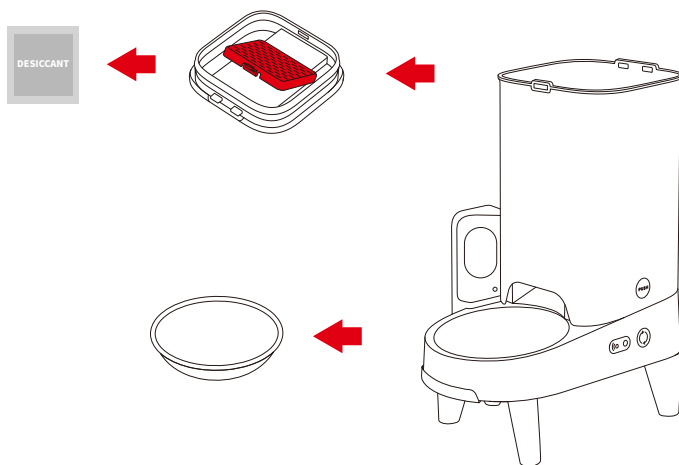

② Hold the PUSH buttons on both sides, and lift up to remove the hopper.

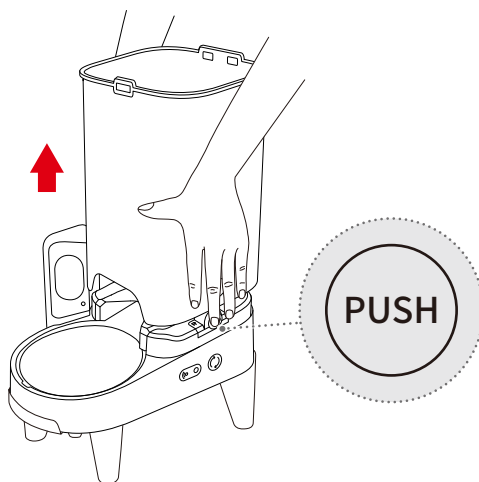

- ③ Pull out the food dispensing vanes in the hopper. Rotate clockwise to remove the impeller cover and take out the impeller.

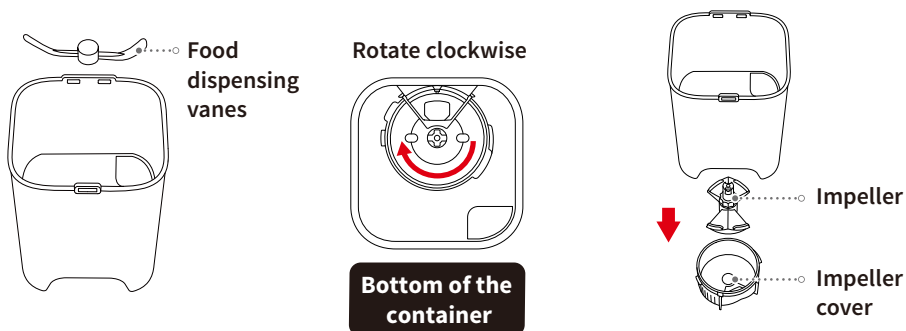

- ④ Wipe the main unit and elevated stands with a soft cloth. To clean the elevated stands, turn the feeder upside down and pull the elevated stands out.

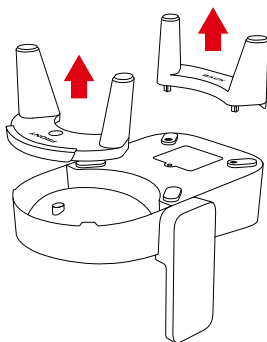

- ⑤ Clean the hopper, vanes, impeller cover, impeller, upper lid and food bowl in turn. It is recommended to add appropriate amount of detergent and rinse well.

- ⑥ After cleaning, wait for each part to dry completely and install them back in turn.

\* Please refer to the maintenance & cleaning video for detailed steps.



**Clean the hopper interior with a sponge or soft cloth; avoid harsh tools to prevent scratching plastic parts or damaging the sensor. Do not immerse the main unit in water; wipe with a damp tissue instead.**

# 07 VIDEO GUIDE

## 7.1 Installation & Usage Video



Click to view

## 7.2 Cleaning and Maintenance Video



Click to view

# 08 BASIC SPECIFICATIONS

Name	PETKIT YUMSHARE SOLO 2 WITH CAMERA SMART PET FEEDER
Weight (with elevated stand)	About 3.94 lb (1.79 kg)
Dimensions	with elevated stand: 15.07*7.32*11.81 in (383*186*300 mm) without elevated stand: 12.44*7.32*11.65 in (316*186*296 mm)
Model	P572
Capacity	3L
Rated Input	6V $\equiv$ 2A
Connection	2.4 & 5GHz Wi-Fi
Scope of Application	Cats and small-breed dogs

# 10 TO OUR VALUED USERS

- Thank you for choosing the PETKIT YUMSHARE SOLO 2 WITH CAMERA SELF-CLEANING CAT LITTER BOX.
- Please read the user manual carefully before installing and using the product. Any installation or usage indicates that you have read and accepted the safety instructions below.
- PETKIT is not responsible for or legally liable for any accidents or injuries resulting from the improper use of the product.
- PETKIT reserves the right to interpretation and revision.

# 11 SAFETY INSTRUCTIONS

\* Failure to follow the safety guides outlined below can result in product malfunction or other unforeseen mishaps.

- Install and use the product in accordance with the instructions.
- Do not disassemble the camera with force.
- Do not scratch the camera with sharp objects.
- Use the product indoors only. Avoid placing it in direct sunlight or near fire sources.
- This product is powered by safe low voltage, but pet biting of wires may still cause electric leakage. Please secure and hide the power cord during use to prevent pet biting. If pet biting is observed, stop it immediately.
- Use the original adapter only. Using non-original adapters may damage the device or pose a safety hazard.
- Place it on a level surface. Do not tip over the device to prevent safety hazards.
- Do not put items other than pet food in the hopper, as this may cause abnormal operation of the device or even pose safety risks to pets.
- To prevent pets from knocking over the product, it is recommended to place it in a corner or against a wall.
- Do not place this product at a high location to avoid damage to the product or safety risks to pets due to falling.
- The main unit of this product must not be immersed or soaked in water, and the entire unit should not be used in a humid environment.
- After cleaning the hopper, ensure all components are completely dry before reassembling and using the product.
- If you want to stop using the product, remove the batteries, unplug the power cord, clean and dry it before storage.
- Please unplug the power cord before moving the product.
- Children should use this device under the guidance of adults
- For safety reasons, please do not attempt to repair this product yourself—repairs should only be carried out by qualified maintenance personnel to prevent accidental injury.
- If you will be away from home for an extended period, please check the batteries to ensure they are fully charged (this product is only compatible with alkaline batteries).
- Contact customer service promptly if any issues arise during product use.

## Disposal

The European directive 2012 / 19 / CE on Waste Electrical and Electronic Equipment(WEEE), requires that old household electrical appliances must not be disposed in the normal unsorted municipal waste stream. Old appliances must be collected separately in order to optimize the recovery and recycling of the materials they contain and reduce the impact on human health and the environment. The crossed out "wheeled bin" symbol on the product reminds you of your obligation, that when you dispose of the appliance it must be separately collected. Consumers should contact their local authority or retailer for information concerning the correct disposal of their old appliance.

This device complies with part 15 of the FCC Rules. Operation is subject to the following two conditions:  
 (1) This device may not cause harmful interference, and ;  
 (2) this device must accept any interference received, including interference that may cause undesired operation.

FCC warning:

Any Changes or modifications not expressly approved by the party responsible for compliance could void the user's authority to operate the equipment.

Note: This equipment has been tested and found to comply with the limits for a Class B digital device, pursuant to part 15 of the FCC Rules. These limits are designed to provide reasonable protection against harmful interference in a residential installation. This equipment generates uses and can radiate radio frequency energy and, if not installed and used in accordance with the instructions, may cause harmful interference to radio communications. However, there is no guarantee that interference will not occur in a particular installation. If this equipment does cause harmful interference to radio or television reception, which can be determined by turning the equipment off and on, the user is encouraged to try to correct the interference by one or more of the following measures:

-Reorient or relocate the receiving antenna.

-Increase the separation between the equipment and receiver.

-Connect the equipment into an outlet on a circuit different from that to which the receiver is connected.  
 -Consult the dealer or an experienced radio/TV technician for help.

The device has been evaluated to meet general RF exposure requirement.

This equipment complies with FCC radiation exposure limits set forth for an uncontrolled environment. This equipment should be installed and operated with minimum distance 20cm between the radiator & your body.

IC warning

- English:

This device complies with Industry Canada licence-exempt RSS standard(s). Operation is subject to the following two conditions:

(1) This device may not cause interference, and

(2) This device must accept any interference, including interference that may cause undesired operation of the device.

- French:

Le présent appareil est conforme aux CNR d'Industrie Canada applicables aux appareils radio exempts de licence. L'exploitation est autorisée aux deux conditions suivantes:

(1) l'appareil ne doit pas produire de brouillage, et

(2) l'utilisateur de l'appareil doit accepter tout brouillage radioélectrique subi, même si le brouillage est susceptible d'en compromettre le fonctionnement.

