

# PETKIT™

## USER MANUAL

PETKIT PUROBOT™ CRYSTAL DUO WITH CAMERA  
SELF-CLEANING CAT LITTER BOX



Please read the user manual carefully before using the product and keep it properly.

# TABLE OF CONTENTS

**PACKAGE LIST ..... 3**

**PRODUCT DESCRIPTION ..... 4**

**PRODUCT INSTALLATION ..... 5**

**PRODUCT USAGE ..... 8**

**APP FUNCTIONS ..... 11**

**CLEANING AND MAINTENANCE ..... 24**

**VIDEO GUIDE ..... 25**

**BASIC SPECIFICATIONS ..... 25**

**TO OUR VALUED USERS ..... 26**

**SAFETY INSTRUCTIONS ..... 26**

# 01 PACKAGE LIST

\*This product consists of three major modules: the main unit, AI camera, and litter tray.  
Before installation and use, please check whether the accessories are complete according to the list.



**Main Unit x1**



**AI Camera x1**  
self-installation  
needed



**Crystal Litter Tray x1**  
already installed



**Crystal Cat Litter x1**



**Back Cover of  
AI Camera x1**



**Screw x4**



**Hex Key x1**



**Pet Odor  
Eliminator N60 x1**



**Trash Bag x1**  
put the used tray in it



**Power Adapter x1**

# 02 PRODUCT DESCRIPTION

## AI Camera

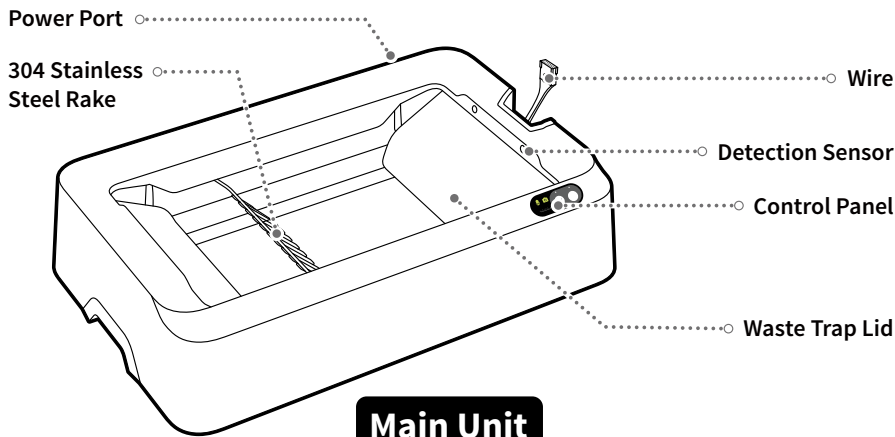
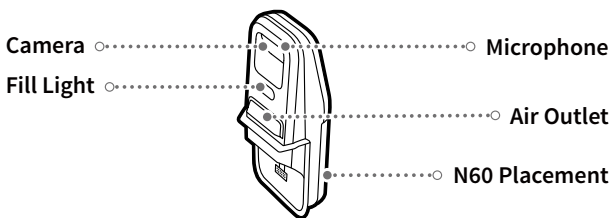

## Main Unit

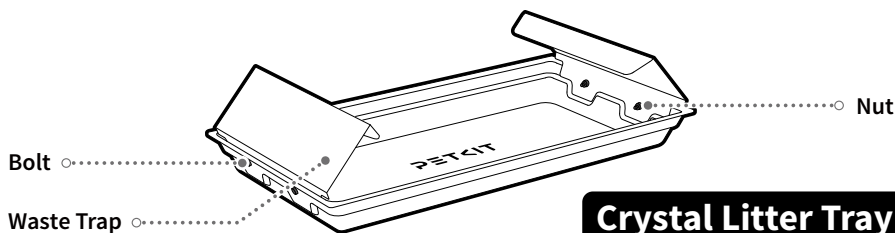

## Crystal Litter Tray

\*Due to continuous product improvements, there may be slight differences in the actual product (including but not limited to appearance, structure, and color). The product images displayed on packaging and promotional materials are for reference only.

# 03 PRODUCT INSTALLATION

## ⚠ Tips for Installation

- Place the product on a level surface, leaving sufficient space in front (logo side) for installation and maintenance.
- The AI camera needs to be secured with screws. Please find the required tools from the accessories in advance.
- Place the product near a stable Wi-Fi connection.

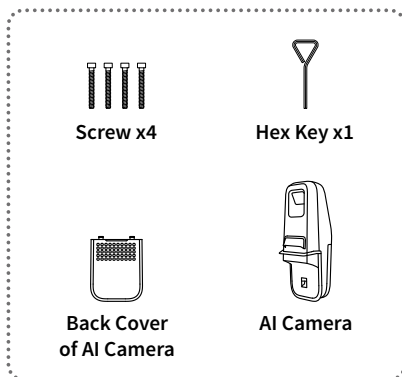
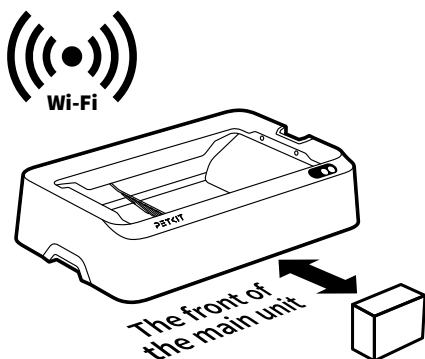

❶ Insert the unit's wire into the AI camera interface.

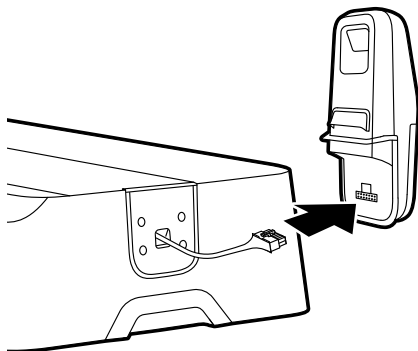

❷ Insert the AI camera into the unit's mounting slot and hold it in place. Install the four screws and tighten them with the hex key.

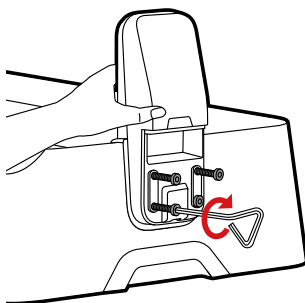

- ③ Take out the N60, install it, then push the back cover upward.

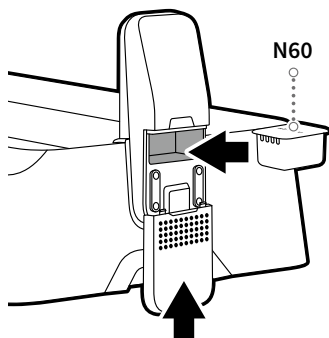

- ④ Connect the power supply. If the tray indicator light stays solid green, the tray is installed correctly.

If the indicator flashes red, disconnect the power supply, lift the main unit from the front, and turn the tray around to ensure that the tray identification sticker is on the same side as the camera. Then place the main unit down.

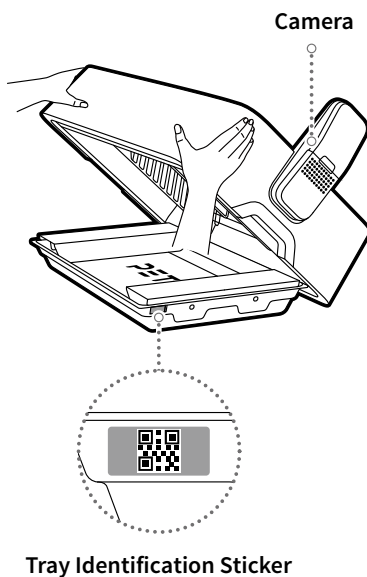
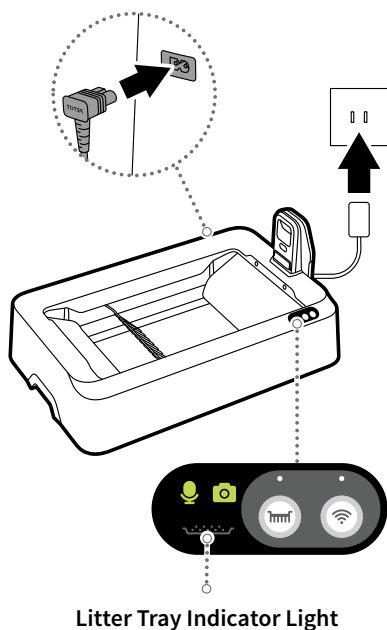

- 5 Pour the crystal cat litter into the tray evenly.

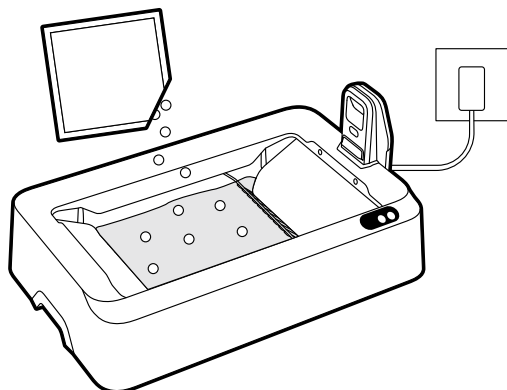

## Indicator Light and Button Instructions

### Camera Indicator Light ▼

**Solid Green:** Enabled  
**Light off:** Disabled

### Microphone Indicator Light ▼

**Solid Green:** Enabled  
**Light off:** Disabled

### Litter Tray Indicator Light ▼

**Solid Green:** Installed properly  
**Flashing Red:** Not installed  
**Solid Red:** Replace now

### Cleaning Button ▼

**Press:** Start cleaning / Stop cleaning

### Cleaning Indicator Light ▼

**Solid Green:** Cleaning in progress  
**Slow Flashing Green:** Cleaning paused

### Wi-Fi Indicator Light ▼

**Slow Flashing Green:** Device offline  
**Fast Flashing Green:** Connecting...  
**Solid Green:** Connected

### Wi-Fi Setup Button ▼

**Press and Hold:** Connect to Wi-Fi

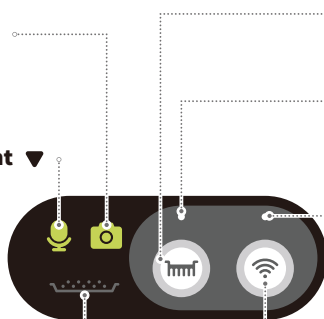

# 04 PRODUCT USAGE

## 4.1 Device Binding

**Note:** Please bind the app before using the device for the first time. The device can be used only after successful binding.

### 1 Download and Install the App

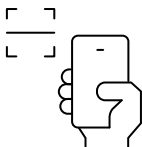

Download the PETKIT App from the App Store or Google Play. Or scan the QR code to download it.

### 2 Add the Device

Open the App, tap "+" to add the device, then choose "PETKIT PUROBOT™ CRYSTAL DUO WITH CAMERA SELF-CLEANING CAT LITTER BOX".

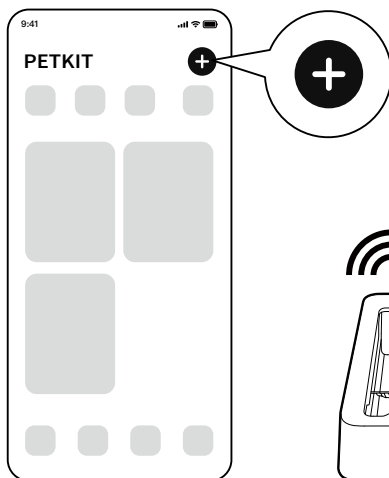

\* Note: Interface may vary due to irregular software updates, please refer to the actual one.



### 3 Start connection

Bind the device as guided on the page. The "Wi-Fi Indicator Light" on the device flashing green rapidly means it is connecting to the device; please wait patiently until the connection is successful.

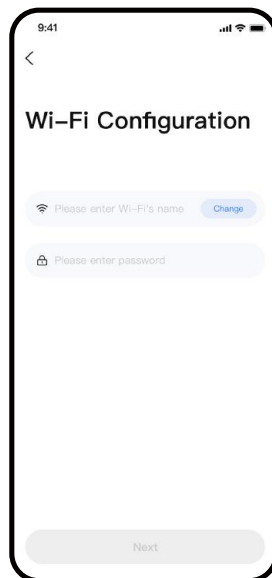
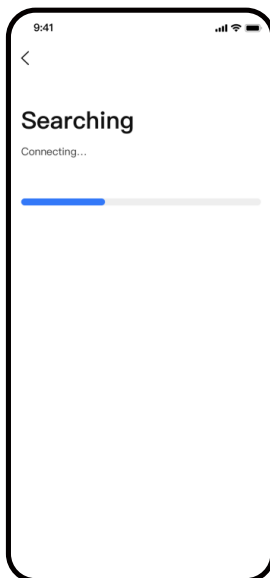

\* Note: Interface may vary due to irregular software updates, please refer to the actual one.

#### 4 Read usage instructions

To ensure pet safety and proper use of the product, please carefully read the usage instructions and use the product as directed.

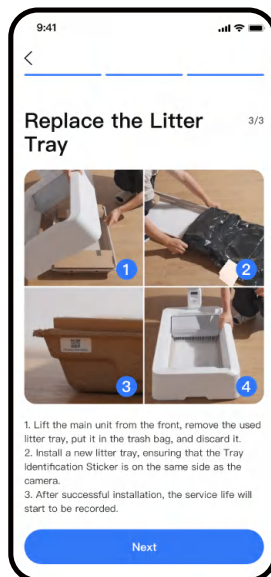
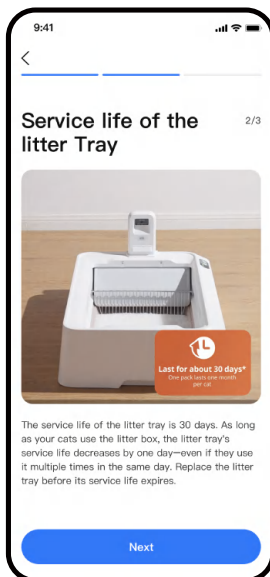
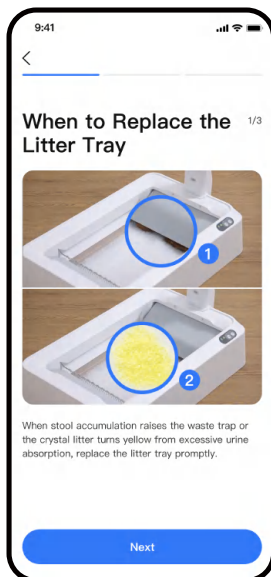

# 05 APP FUNCTIONS

## 5.1 Device Homepage

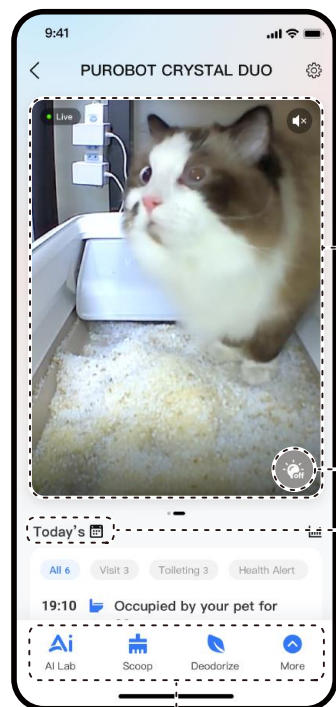

❶ **Live View:** View your pet's status in real-time.

❷ **Fill Light:** Turn on or turn off the light of camera.

❸ **Today's:**

Video captured are categorized as toileting and health alert through AI algorithm. You can click them for more details.

\*For features such as full video playback, please subscribe to the PETKIT Care+ cloud service. You can refer to the PETKIT Care+ Service Agreement for more details.

❹ **Function Keys**

## 5.2 Reminder of N60 and Litter Tray

Swipe left to view the usage status of N60 and litter tray.

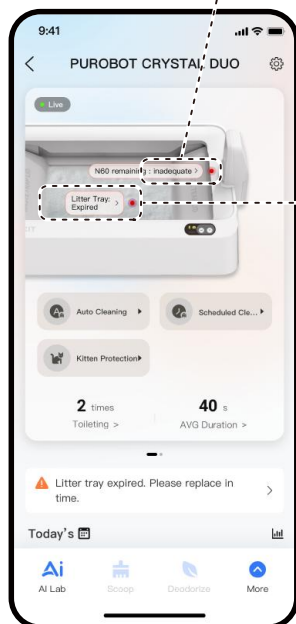
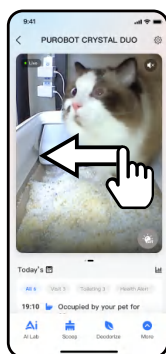

### 1 N60 replacement reminder

- ▶ If the N60's label turns red and shows "Expired", please replace it in time, Then click "Reset" after replacement. "Normal" means successful installation.

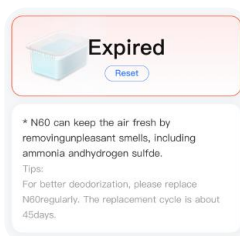

### 2 Litter tray

- ▶ "Normal" means successful installation.
- ▶ "Not installed" means the tray is installed incorrectly.
- ▶ "Expired" means you need to replace it with a new one.

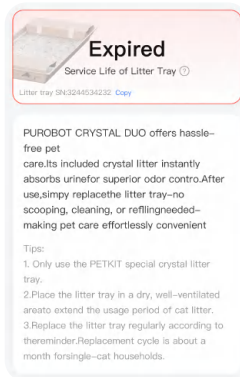
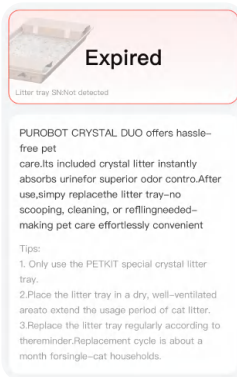

## 5.3 Description of function keys

### ① AI Lab

Click on "AI Lab" and you can turn on the Yowling Detection, Urine pH Detection, and other features.

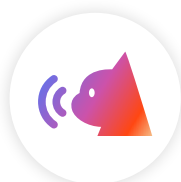
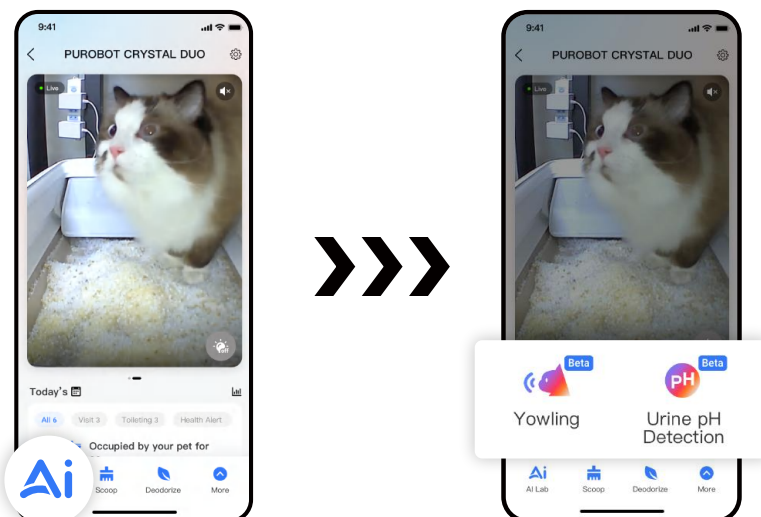

### Yowling Detection

When turned on, cat's yowling during litter box usage will be detected and it will send an alert to the pet owner.

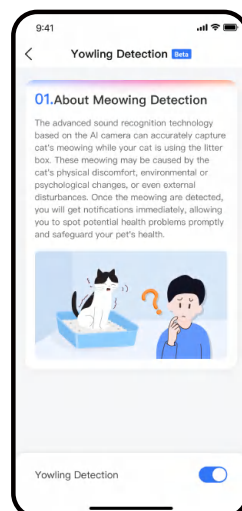

\* Note: Interface may vary due to irregular software updates, please refer to the actual one.



## Urine pH Detection

When turned on, the camera can capture color change of pH test particles and send an alert to the pet owner.

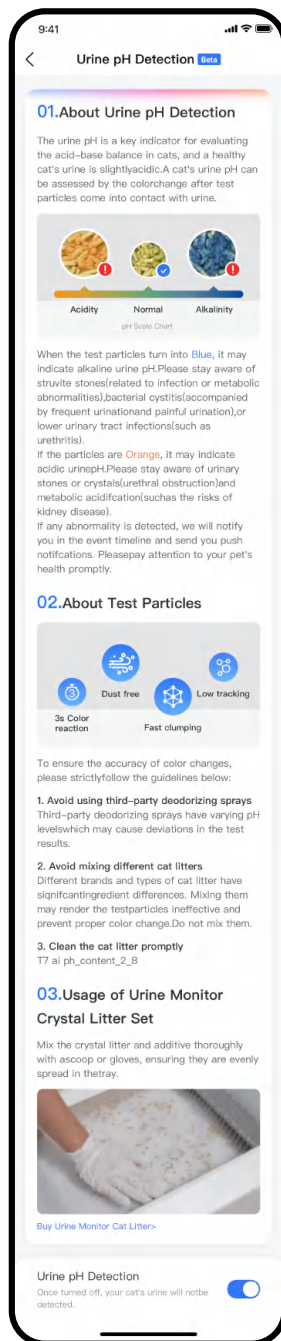

## ② Scoop

Click "Scoop" to clean waste in the litter box.

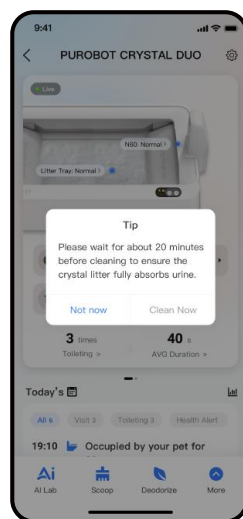
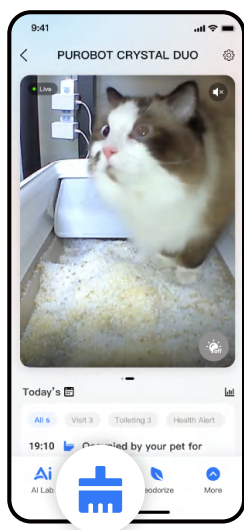

### 3 Deodorize

Click "Deodorize" to start deodorizing with N60.

Customize deodorizing modes in Cleaning Setting, three deodorizing modes are available: auto deodorizing, scheduled deodorizing, and deep deodorizing.

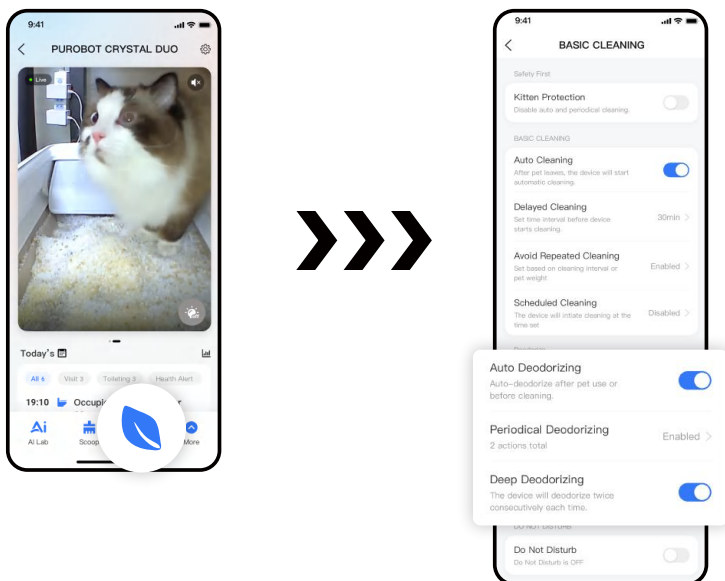

### 4 Lighting

Click "Light" to turn on or turn off the fill light of the camera.

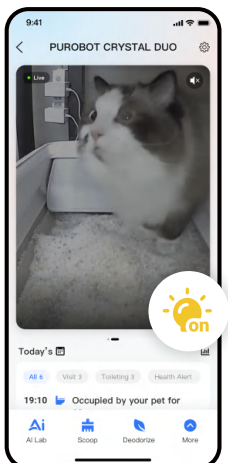

\* Note: Interface may vary due to irregular software updates, please refer to the actual one.



## 5 Level

Click "Level" for even cat litter distribution.

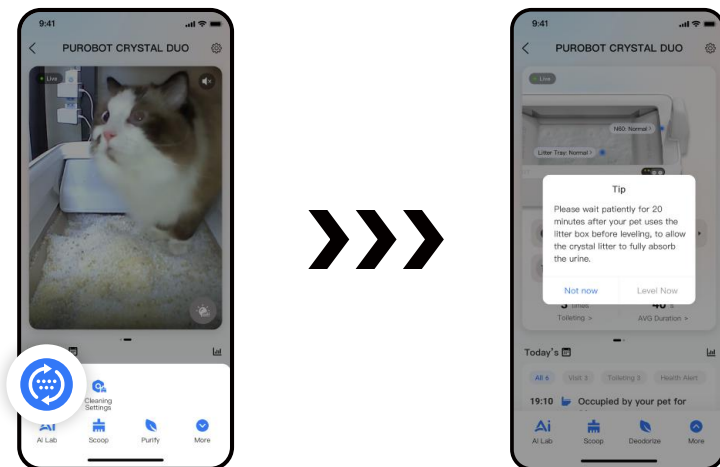

## 5.4 Three Ways to Play Videos

After subscribing to the PETKIT Care+ service, you can view full videos, highlight clips, or choose to use speed-up playback.

### 1 Highlight clips

Click event video in the timeline to view a 4-second accelerated preview of the video.



\* Note: Interface may vary due to irregular software updates, please refer to the actual one.

## ② Full video playback

Click "Playback" to watch complete video clips.

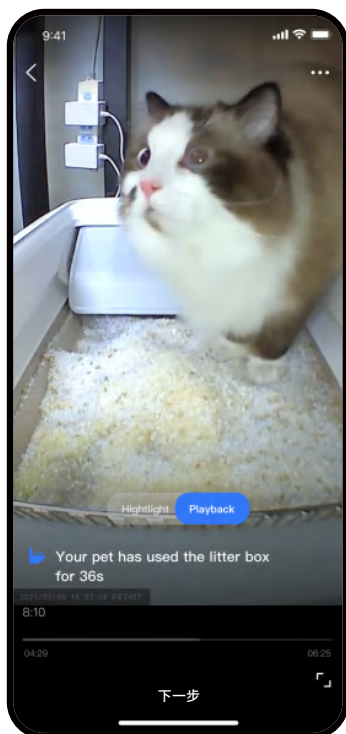

## ③ Speedup playback

When playing full videos, click "⋮" on the top right corner to choose the speed as needed, or long press the center of video to directly switch to 2x playback.

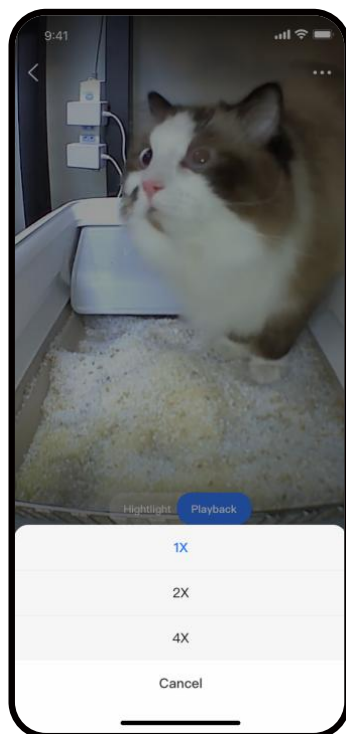

## 5.5 Delete Video Clips

You can choose to delete any video.

### ❶ Method 1:

In the timeline, swipe the target video left and then delete it.

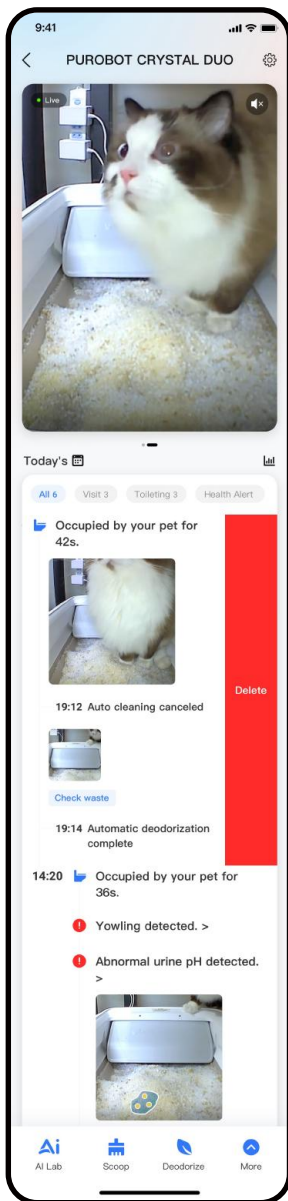

### ❷ Method 2:

Click the video you want to remove, turn its play tag to "Playback" and click the "... " on the top right corner to delete it.

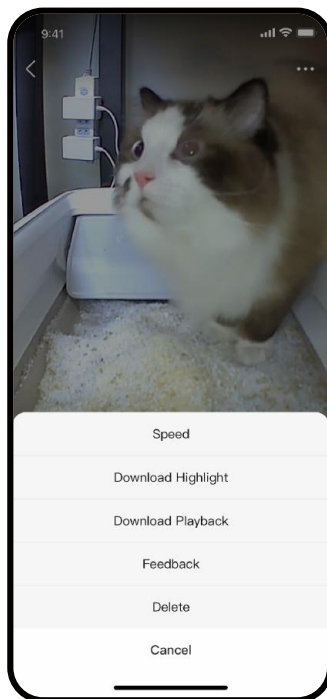

\* Note: Interface may vary due to irregular software updates, please refer to the actual one.

## 5.6 Privacy Protection

### ① Camera permissions

You can turn on or turn off the camera directly as needed.

**Note: After the camera is turned off, no video will be recorded.**

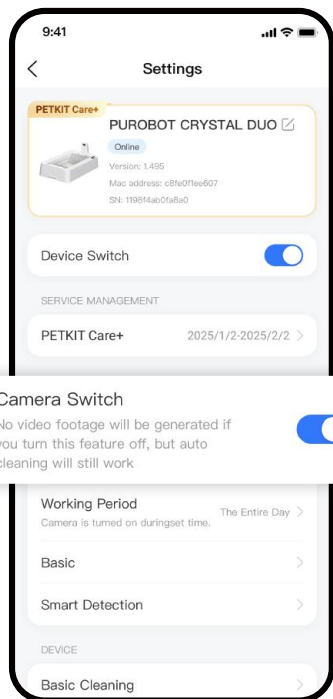

### ② Customize shooting period

You can customize the time periods when the camera is on. Outside these periods, the camera will automatically turn off.

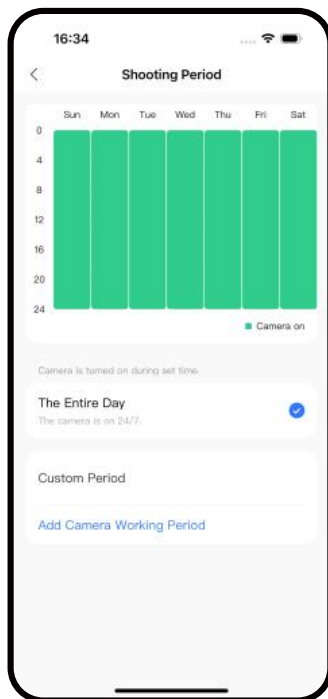

### ③ Live view privacy protection

After this feature is enabled, the live view will appear blurred on the device homepage to protect your privacy.

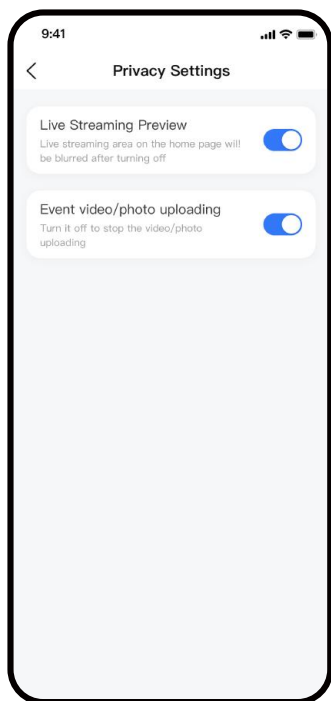

## 5.7 Additional Notes

### ❶ Indicator Light

The indicator light stays on continuously when the camera is activated; it turns off when the camera is deactivated.

### ❷ Make fecal picture clearer

You can turn on the Light Assist in Setting > Light Assist.

#### Light Assist for Toileting:

The light will be turned on automatically when the cat enters the litter box.

#### Light Assist for Cleaning:

The light will be turned on automatically when cleaning cycle starts.

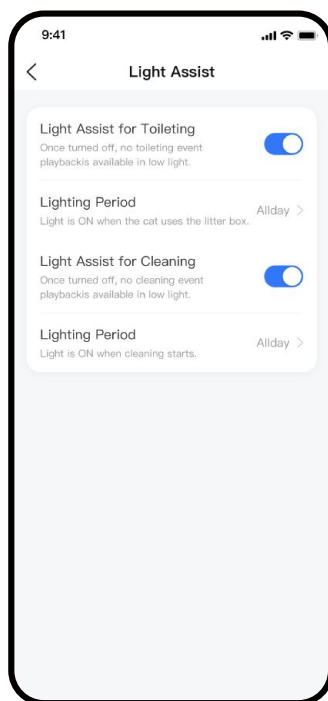
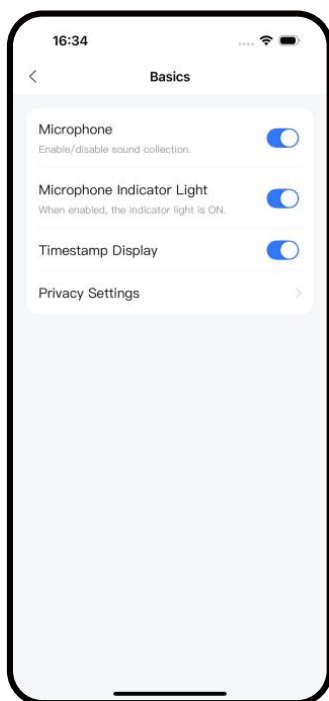

### **③ Cloud Storage**

Videos are stored for a limited time, and stored videos exceeding the time will be periodically cleared. (e.g., 7-day loop means that videos or pictures from the last 7 days are retained, and content from the eighth day forward is automatically cleared.) All videos can be downloaded, and the downloaded videos can be viewed in the local album of your phone and in the App album.

### **④ PETKIT Care+ service**

After subscribing to the PETKIT Care+ service, HD video complete playback and other privileges are available. The details are subject to the page description. PETKIT Care+ service can be transferred to another PETKIT PUROBOT ULTRA, which is only once a year. PETKIT Care+ service is a virtual commodity and is non-refundable once purchased.



**Click here to view the PETKIT Care+ Service Agreement.**

# 07 CLEANING AND MAINTENANCE

**WARNING:** Do not submerge or expose the main unit to water. Only wipe it with a damp tissue; otherwise, device damage may occur.

① When the tray indicator light stays solid red, lift the main unit and remove the used litter tray.

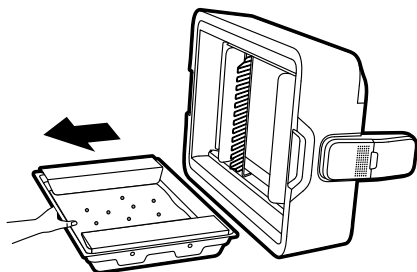

Litter Tray  
Indicator Light



② Place it in the trash bag and discard it.

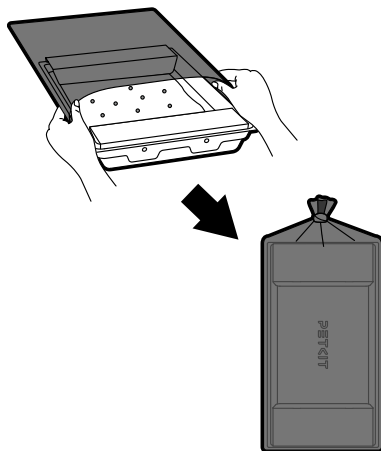

③ Use a damp tissue to wipe the waste trap lid, rake, main unit, and other soiled parts.

**CAUTION:** Disconnect the power supply before cleaning.

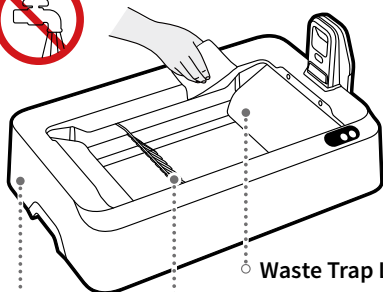

④ If both waste trap lids are heavily soiled, they can be removed for cleaning. After air-drying, reassemble them one by one. (Scan the QR code to watch the maintenance video for detailed steps.)

⑤ Replace the tray and cat litter with new ones. (Refer to the instruction manual inside the PETKIT CRYSTAL LITTER SET for detailed steps.)



# 08 VIDEO GUIDE

## Installation and Maintenance Video

Please copy the video URL and open it in your browser to view the video.

<https://www.youtube.com/watch?v=mL6VG9yH8EE>

# 09 BASIC SPECIFICATIONS

Name	PETKIT PUROBOT™ CRYSTAL DUO WITH CAMERA SELF-CLEANING CAT LITTER BOX
Model	P9905
Materials	ABS, Silicone
Dimensions	32.20*19.96*13.14 in (818*507*334 mm )
Weight	about 12.45 lb (5.65 kg)
Rated Input	12V == 2A
App Connection	Wi-Fi
Scope of Application	For cats aged 6 months or older, weighing over 3.3 lb (1.5 kg).

# 10 TO OUR VALUED USERS

- Thank you for choosing the PETKIT PUROBOT™ CRYSTAL DUO WITH CAMERA SELF-CLEANING CAT LITTER BOX.
- Please read the user manual carefully before installing and using the product. Any installation or usage indicates that you have read and accepted the safety instructions below.
- PETKIT is not responsible for or legally liable for any accidents or injuries resulting from the improper use of the product.
- PETKIT reserves the right to interpretation and revision.

# 11 SAFETY INSTRUCTIONS

**\* Failure to follow the safety instructions below may cause product malfunction or other unforeseen damages.**

- Do not use crystal cat litter or litter trays from other brands or types. Using other litter trays will cause the product to become ineffective and unusable.
- Do not use any other types of cat litter, such as tofu litter or clay litter.
- Install and use the product strictly in accordance with the instructions.
- Cats under 6 months old or weighing less than 3.3 lb (1.5 kg) are strictly prohibited from using this product.
- Do not drag or forcefully bend the AI camera.
- Do not scratch the camera with sharp objects.
- This product is powered by safe low voltage, but pet biting of wires may still cause electric leakage. Please secure and hide the power cord during use to prevent pet biting. If pet biting is observed, stop it immediately.
- Do not place the product in high-temperature or high-humidity environments.
- Use the product indoors only. Avoid placing it in direct sunlight or near fire sources.
- Use the original adapter only. Using non-original adapters may damage the device or pose a safety hazard.
- Do not tip over the device to prevent safety hazards.
- Do not immerse the main unit in water.
- Unplug the power cord if the product is not used for an extended period.
- Children should use this product under adult supervision.
- Repairs must be performed under the guidance of professional personnel to prevent accidental injuries.
- Do not place objects on the top of the device or press it to avoid affecting its normal operation.
- Before extended holidays, ensure the litter box has sufficient cat litter and the waste bin has enough space.
- Contact customer service promptly if any issues arise during product use.

## Disposal

The European directive 2012 / 19 / CE on Waste Electrical and Electronic Equipment(WEEE), requires that old household electrical appliances must not be disposed in the normal unsorted municipal waste stream. Old appliances must be collected separately in order to optimize the recovery and recycling of the materials they contain and reduce the impact on human health and the environment. The crossed out "wheeled bin" symbol on the product reminds you of your obligation, that when you dispose of the appliance it must be separately collected. Consumers should contact their local authority or retailer for information concerning the correct disposal of their old appliance.

This device complies with part 15 of the FCC Rules. Operation is subject to the following two conditions:

- (1) This device may not cause harmful interference, and ;
- (2) this device must accept any interference received, including interference that may cause undesired operation.

### FCC warning:

Any Changes or modifications not expressly approved by the party responsible for compliance could void the user's authority to operate the equipment. Note: This equipment has been tested and found to comply with the limits for a Class B digital device, pursuant to part 15 of the FCC Rules. These limits are designed to provide reasonable protection against harmful interference in a residential installation. This equipment generates uses and can radiate radio frequency energy and, if not installed and used in accordance with the instructions, may cause harmful interference to radio communications. However, there is no guarantee that interference will not occur in a particular installation. If this equipment does cause harmful interference to radio or television reception, which can be determined by turning the equipment off and on, the user is encouraged to try to correct the interference by one or more of the following measures:

- Reorient or relocate the receiving antenna.
- Increase the separation between the equipment and receiver.
- Connect the equipment into an outlet on a circuit different from that to which the receiver is connected.
- Consult the dealer or an experienced radio/TV technician for help.

The device has been evaluated to meet general RF exposure requirement.

This equipment complies with FCC radiation exposure limits set forth for an uncontrolled environment. This equipment should be installed and operated with minimum distance 20cm between the radiator & your body.

### IC warning

- English:

This device complies with Industry Canada licence-exempt RSS standard(s). Operation is subject to the following two conditions:

- (1) This device may not cause interference, and
- (2) This device must accept any interference, including interference that may cause undesired operation of the device.

- French:

Le présent appareil est conforme aux CNR d'Industrie Canada applicables aux appareils radio exempts de licence.

L'exploitation est autorisée aux deux conditions suivantes:

- (1) l'appareil ne doit pas produire de brouillage, et
- (2) l'utilisateur de l'appareil doit accepter tout brouillage radioélectrique subi, même si le brouillage est susceptible d'en compromettre le fonctionnement.



PETKIT Network Technology(Shanghai)Co.,Ltd.  
[www.petkit.com](http://www.petkit.com)  
[support@petkit.com](mailto:support@petkit.com)