

PETKIT™

USER MANUAL

PETKIT PUROBOT ULTRA WITH CAMERA
SELF-CLEANING CAT LITTER BOX

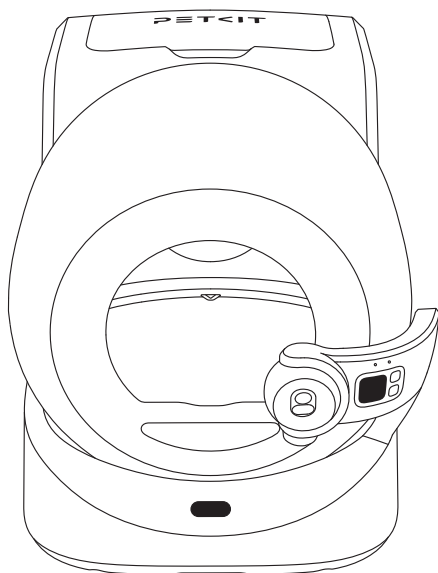

Please read the user manual carefully before
using the product and keep it properly.

TABLE OF CONTENTS

PACKAGE LIST	3
PRODUCT DESCRIPTION	4
PRODUCT INSTALLATION	7
PRODUCT USAGE	10
APP FUNCTIONS	13
INSTRUCTIONS FOR CONTROL PANEL	25
CLEANING AND MAINTENANCE	29
VIDEO GUIDE	35
TROUBLESHOOTING	36
BASIC SPECIFICATIONS	37
A MESSAGE TO OUR VALUED CUSTOMERS	37
SAFETY INSTRUCTIONS	38

01 PACKAGE LIST

* Before installation and use, please take out the accessory box from the trunk and check if all accessories are complete according to the following list:

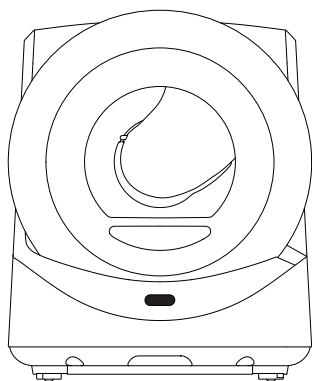

Main Unit

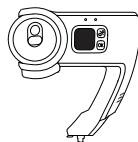

AI Camera

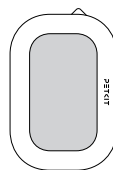

Refill Ring P99034

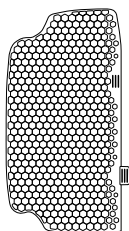

Honeycomb Fine Litter
Sifter P99032 (Exclusive
for mineral cat litter)



Pet Odor
Eliminator N60

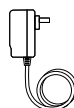

Power Adapter



Screw * 4



Hex Key



User Manual

02 PRODUCT DESCRIPTION

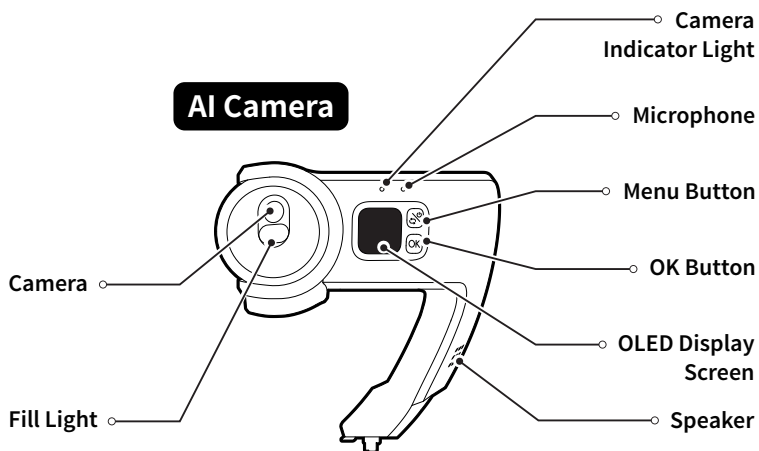
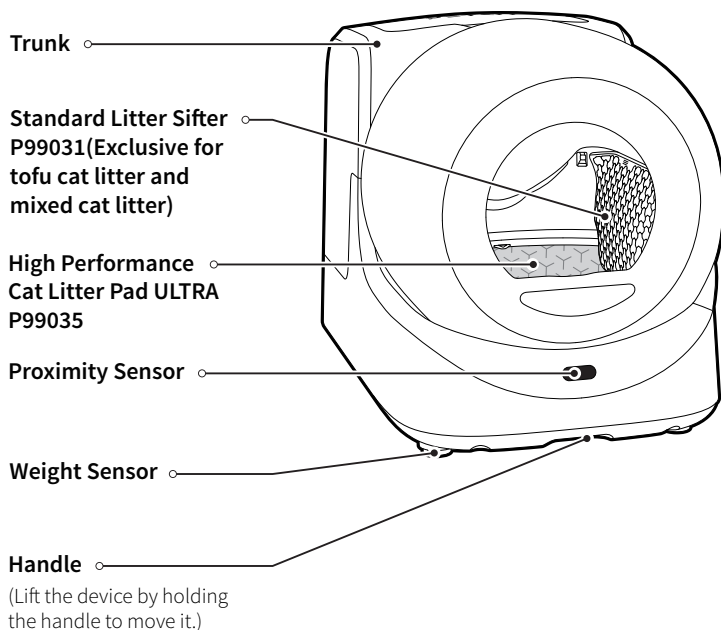

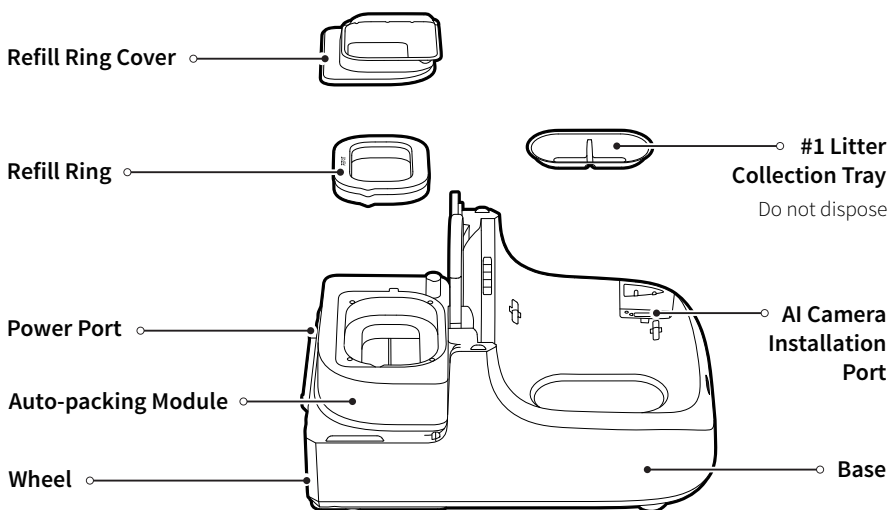
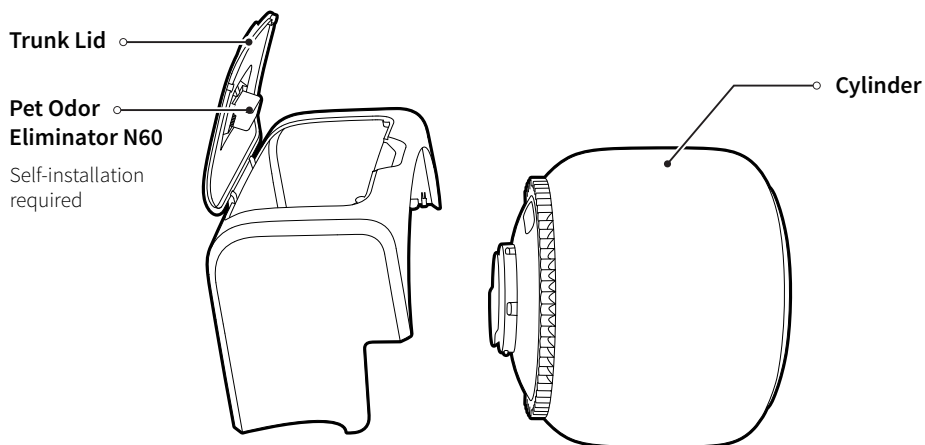

* Note: The actual product may differ from the image shown due to continuous product improvements; the actual product shall prevail.

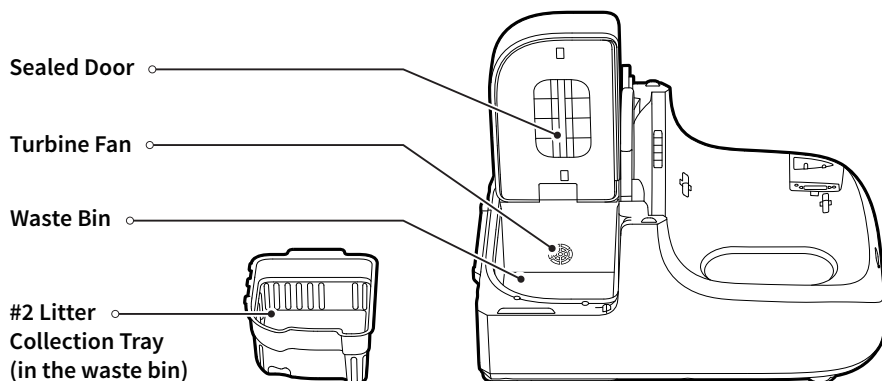

Do not dispose

Component Description

Components	Functional Description
AI Camera	Real-time monitoring of pet's toilet status
Auto-packing Module	Automatically seal and replace the trash bag
Litter Sifter P99031	Effectively sift clumps without jamming or missing; suitable for tofu cat litter and mixed cat litter
Litter Sifter P99032	Effectively sift clumps; suitable for fine granular cat litter such as mineral cat litter and bentonite
High Performance Cat Litter Pad ULTRA P99035*	Non-stick, scratch-resistant, waterproof, and easy to clean
Pet Odor Eliminator N60*	Long-lasting fragrance and non-irritating

* High Performance Cat Litter Pad ULTRA P99035* is hereinafter referred to as litter pad.

* Pet Odor Eliminator N60 is hereinafter referred to as N60.

03 PRODUCT INSTALLATION

3.1 Install AI Camera

- ❶ Unlock the buckle to remove the cylinder.

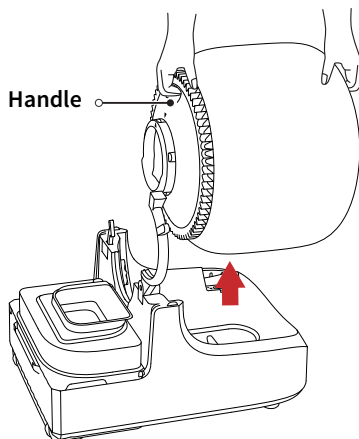
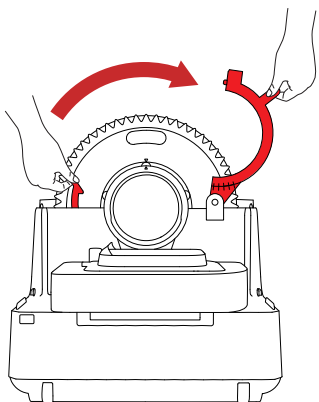

- ❷ Insert the AI camera into the installation port. (as shown in the figure)

- ❸ Install the "1" and "2" screws first (in a horizontal direction), then install the "3" and "4" screws (in a vertical direction), and tighten them with the hex key.

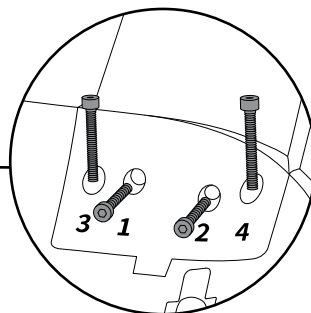
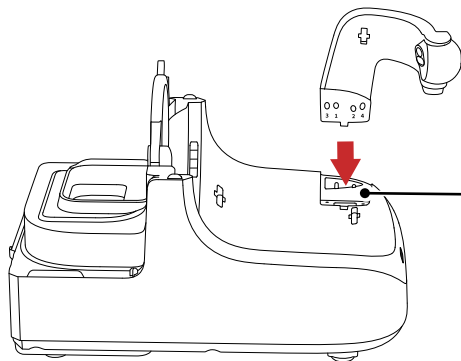

- ④ Place the cylinder on the base and lock the buckle, ensuring it is fastened.

* Handle with care; Do not bump the AI camera.

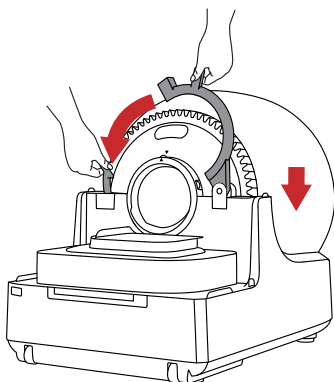

- ② Install the trunk, ensuring that it attaches to the magnets on both sides.

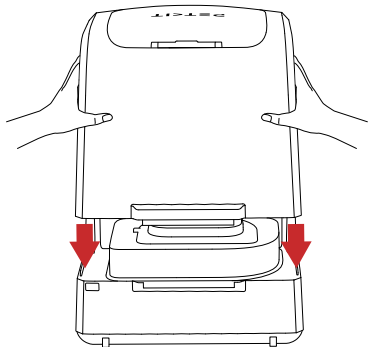

3.2 Install Refill Ring and N60

- ① Remove the refill ring cover, put the refill ring in, and put the cover back.

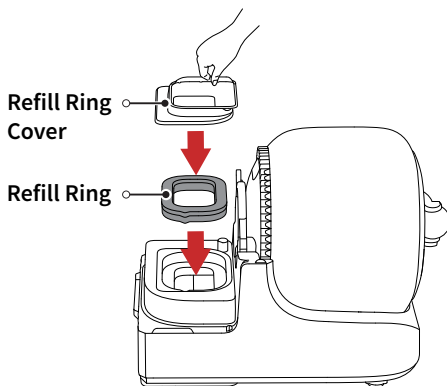

- ③ Open the lid, install the N60, and close the lid.

* Do not place anything on the lid to avoid risks of damaging the device.

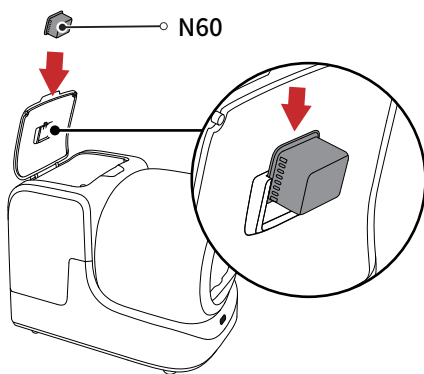

3.3 Power On

❶ Connect to the power supply, and the cylinder will reset automatically.

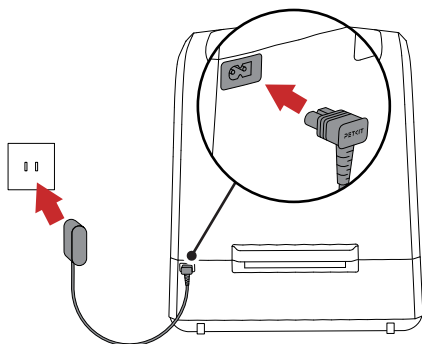

❷ The camera will rotate.

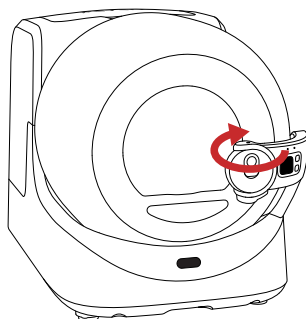

❸ Select the litter sifter according to the cat litter. If it is mineral cat litter, please use the litter sifter P99032. Pour in the cat litter and do not exceed the MAX line.
(See 7.1.2 and 7.2.4 for the replacement method of litter sifter)

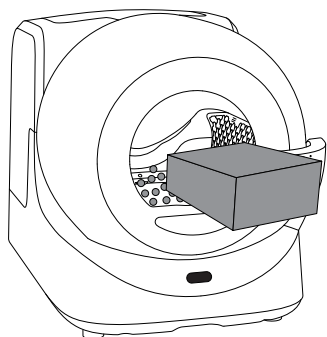

Litter Sifter P99031
(Exclusive for tofu cat litter
and mixed cat litter)

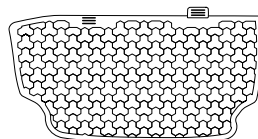

Litter Sifter P99032
(Exclusive for
mineral cat litter)

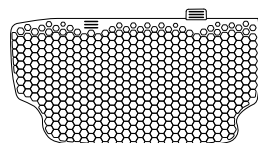

04 PRODUCT USAGE

4.1 Device Binding

* Please bind the device with the app before using it for the first time. The device can be used only after successful binding.

① Download the App

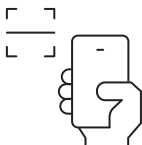

Download the PETKIT App from the App Store or Google Play.
Or scan the QR code to download and install.

② Add the device

Open the app, click “+” and select PETKIT PUROBOT ULTRA WITH CAMERA SELF-CLEANING CAT LITTER BOX.

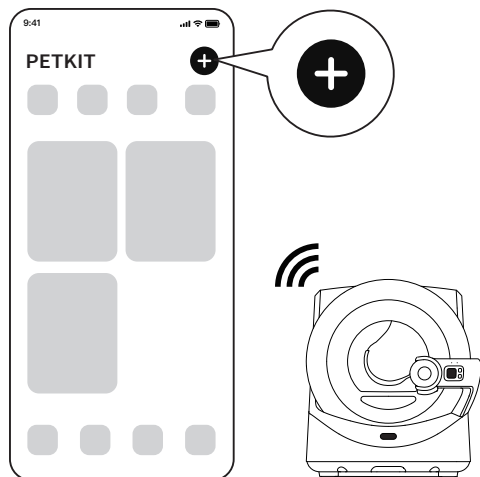

3 Start connection

Press the menu button on the device and switch to “Connect to the network”, then press the OK button, and the screen will display “Connecting”. Please follow the instructions in the App until the binding is successful.

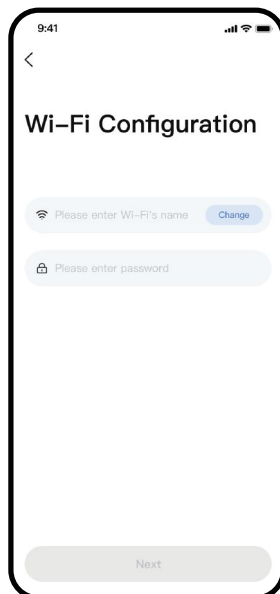
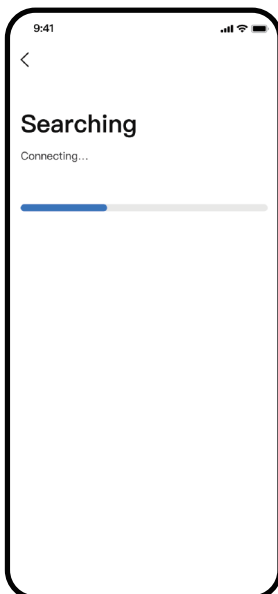

* The interface may be different due to software version update; the actual interface shall prevail.

4 Read instructions

To ensure the safety of pets and the correct use of this product, please read the instructions carefully and use the product properly according to the usage guide after the first successful connection to the device.

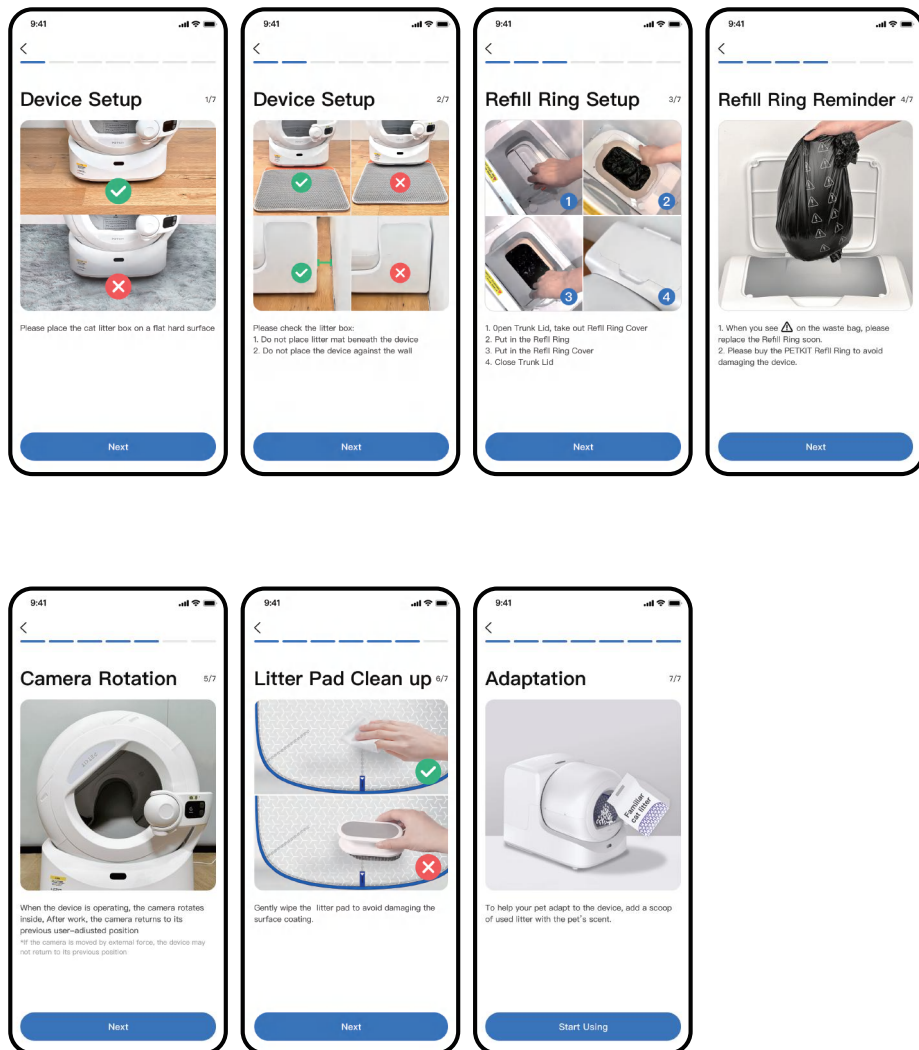

05 APP FUNCTIONS

▲
RETURN TO
CONTENTS

5.1 Homepage

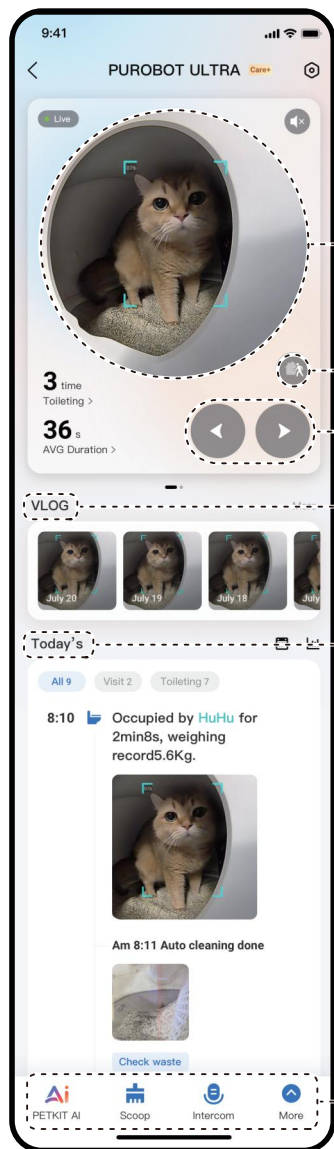

① **Live:** View pet's activities in real time.

② **Privacy Mode:**

When enabled, the camera will default to rotate towards the inside of the cylinder. Additional settings can be configured on the "Privacy Mode" page in the "Settings" menu.

③ **Camera pan:** Adjust the camera angle horizontally.

④ **VLOG:**

Highlight video collections from the previous are automatically generated daily at 8 am.

⑤ **Today's timeline:**

Quickly find and replay saved videos by the event category.

* For features such as full video playback, please subscribe to the PETKIT Care+ cloud service. Please refer to PETKIT Care+ Service Agreement for details.

⑥ **Main functions:** Click "More" to explore more functions.

5.2 N60 and Trash Bag Remaining Indicator

Swipe left on the homepage to view the N60 and Trash Bag usage status.

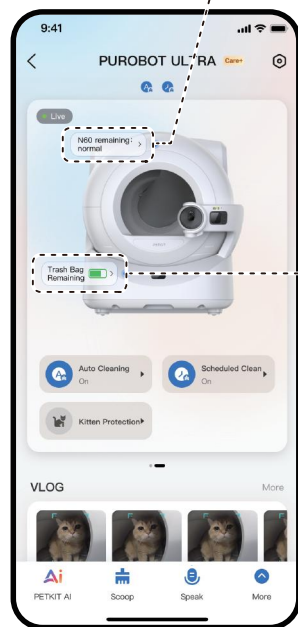
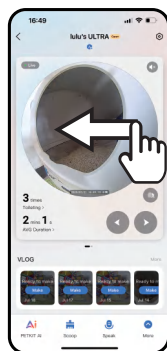

① N60 replacement reminder

If the N60 label turns red and shows “N60 has expired”, please replace it promptly. Click “Reset” after replacing to ensure it shows “Normal”.

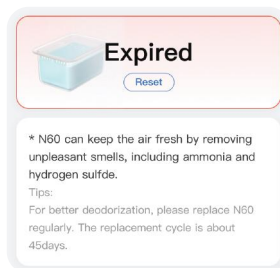

② Refill Ring replacement reminder

If the trash bag label indicates “Out of trash bag”, please replace the Refill Ring promptly.



Tip:

If there are warning signs ⚠ on the packed trash bag, it indicates that the trash bag has run out. Please replace the Refill Ring with a new one.



5.3 Functions

① Scoop

Click to clean out the clumps from the cylinder.

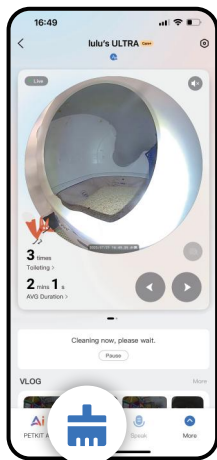

② Speak

Press and hold to talk to your pet.

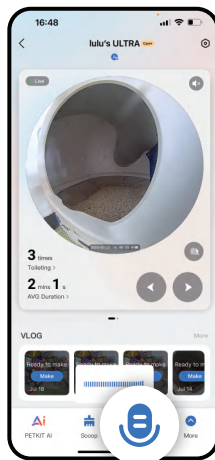

③ Pack

CAUTION: This function needs to be operated on the device control panel. Please stay near the device during packing.

Click to go to the Packing Guide page, then follow the prompts and double press the OK button on the device to start packing.

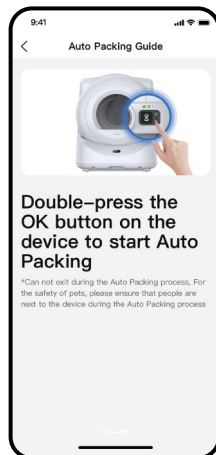
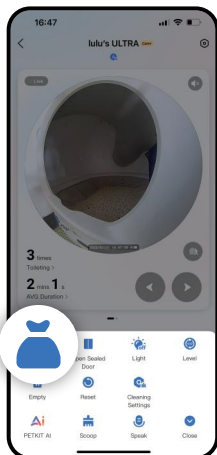

4 Empty

CAUTION: This function needs to be operated on the device control panel.
Please stay near the device during emptying.

Click to go to the Emptying Guide page, then follow the prompts and double press the OK button on the device to start emptying.

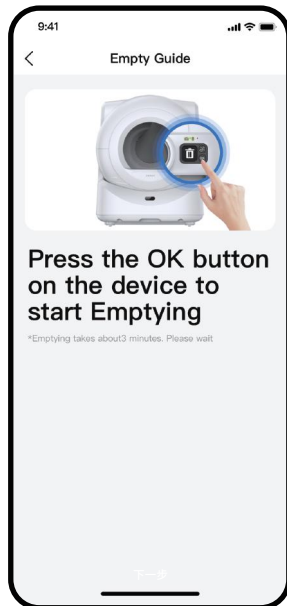
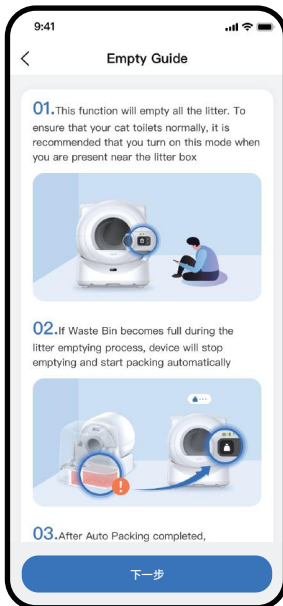
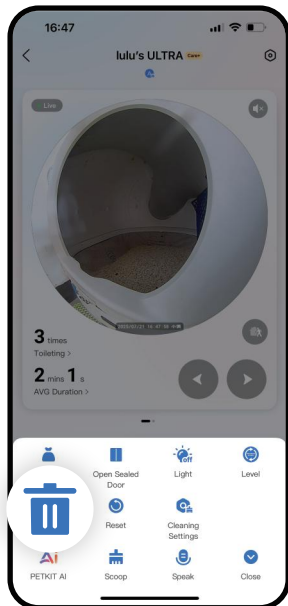

5 Introduction to other functions

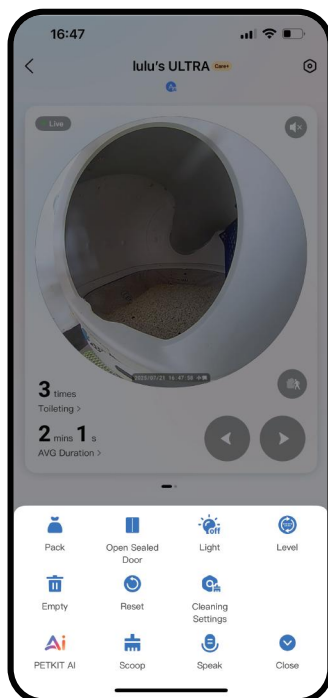

Light

Turn on the fill light in the camera.



Level cat litter

Make cat litter evenly distributed in the cylinder; Use it after refilling cat litter.



Open / Close sealed door

Open or close the sealed door of the auto-packing module.



Reset

Adjust the cylinder to the correct position.

5.4 Footage Playback

After subscribing to PETKIT Care+ service plans, footage playback is accessible.

① Highlight playback

Click the video in the timeline to see the accelerated preview version.

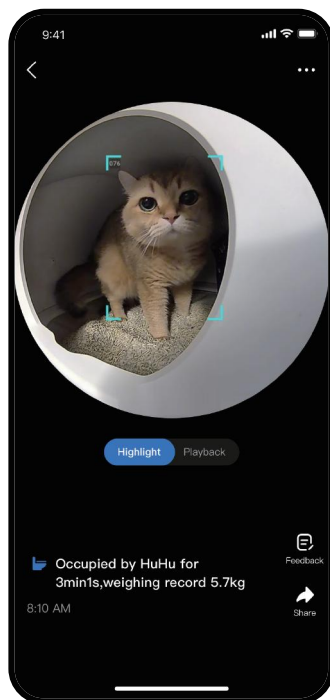
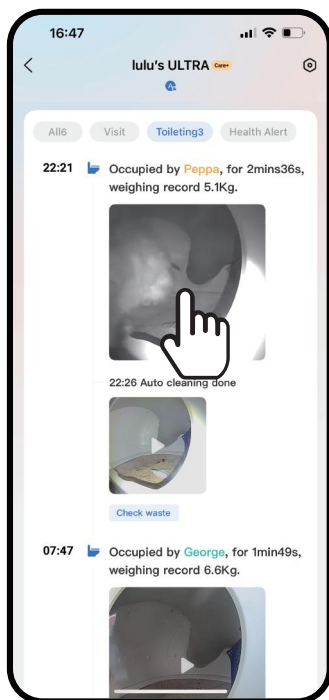

② Full video playback

Click Playback to view the complete video footage.

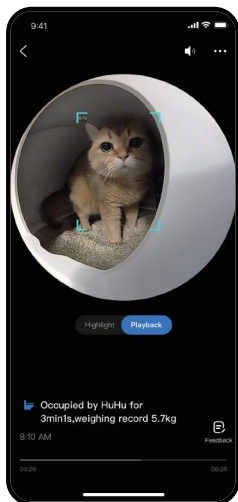

③ Speedup playback

On the Playback page, click “...” n top right to choose the speed, or hold the center of the screen to play in 2x speed.

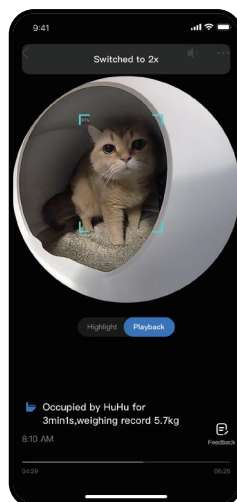
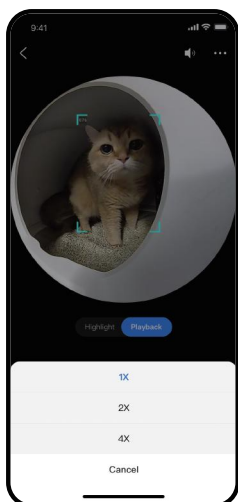

5.5 Delete Footage

Delete the recorded footage as needed.

Method 1:

Swipe left in the timeline and delete the footage.

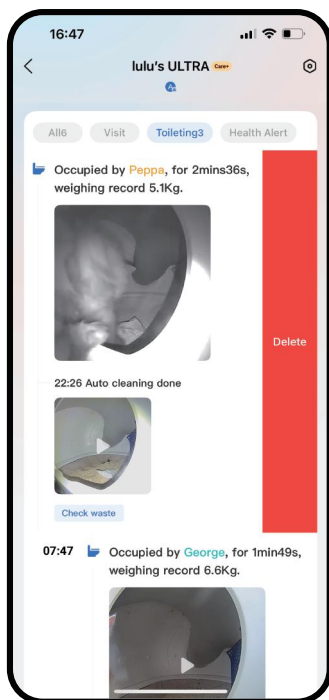

Method 2:

Click the video in the timeline, then click Playback, click “...” on the top right and delete the footage.

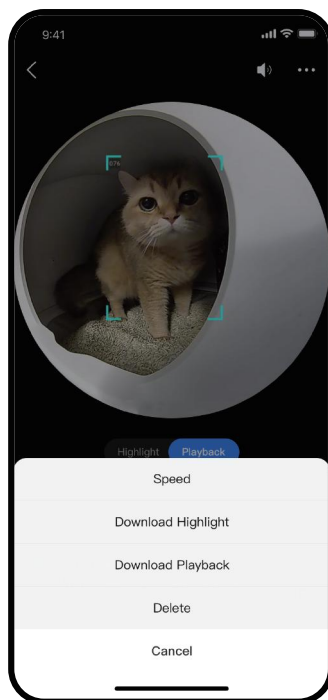

5.6 Privacy Protection

① Activate or deactivate the camera

You can turn on or turn off the camera as you need.

Note: When the camera is turned off, it will automatically turn inside the litter box and stop video recording.

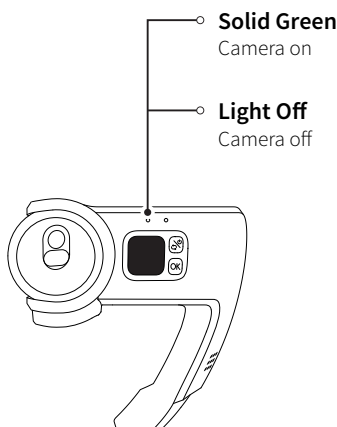
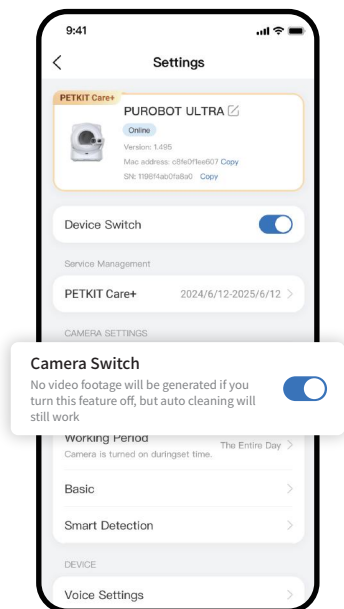

② Customize the camera working time period

You can customize time slots to turn on the camera. Outside those time slots, the camera will be automatically turned off.

Note: Out of the customized periods, the camera will not record videos, but a 5-minute live view is available.

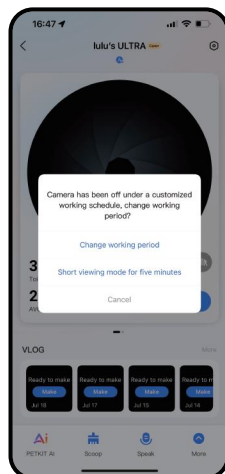
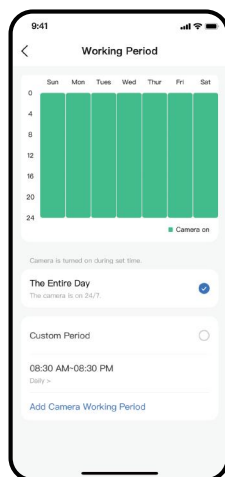

* The interface may be different due to software version update; the actual interface shall prevail.

3 Smart detection

When Pet Visit Detection is turned off, the camera won't record videos of the pet outside the litter box, and events of the pet appearing outside the litter box won't be logged in the timeline.

When Toilet Video Recording is turned off, the camera won't record toileting videos, but toileting logs will still be displayed in the timeline.

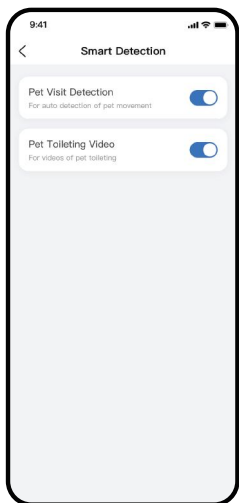

4 Privacy protection of live view

With this feature on, the live view will be blurred when you enter the device homepage to protect your privacy.

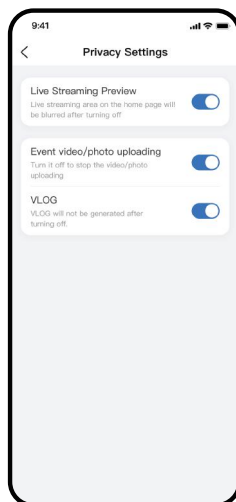
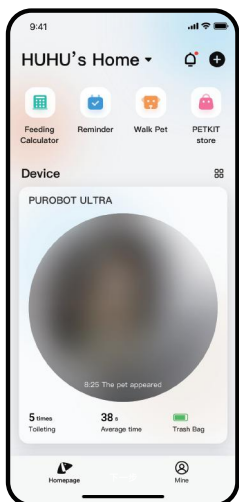

5.7 Other Settings

① Make fecal pictures clearer

You can turn on the Light Assist for Toileting and Light Assist for Cleaning in [Settings > Cleaning Settings]. Once turned on, the light will automatically turn on every time your pet uses the litter box or cleaning cycle starts, and the light will turn off after your pet leaves or cleaning cycle ends.

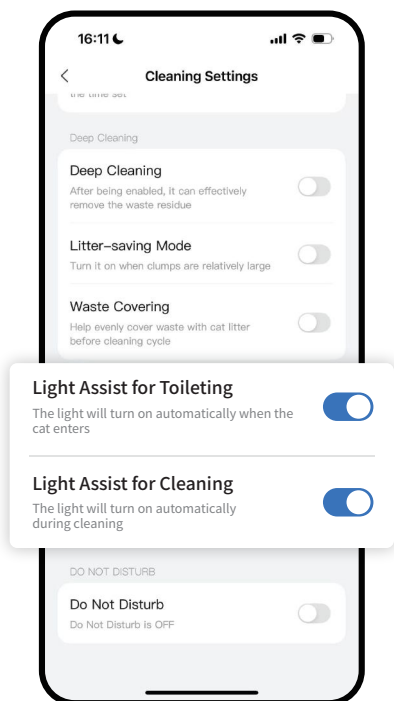

② Turn off voice prompt

Method 1: Go to Settings > Voice Settings and turn off Voice Prompt.

Method 2: Go to Settings > Voice Settings and turn on Do Not Disturb and set the undisturbed period.

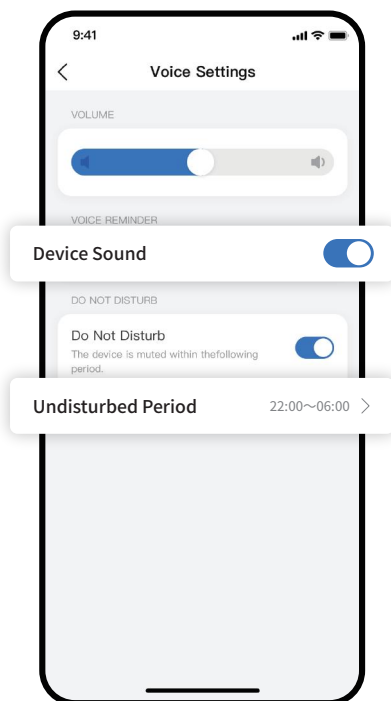

③ Cloud Storage

Videos are stored for a limited time, and stored videos exceeding the time will be periodically cleared. (e.g., 7-day loop means that videos or pictures from the last 7 days are retained, and content from the eighth day forward is automatically cleared.) All videos can be downloaded, and the downloaded videos can be viewed in the local album of your phone and in the App album.

④ PETKIT Care+ service



After subscribing to the PETKIT Care+ service, HD video complete playback and other privileges are available. The details are subject to the page description. PETKIT Care+ service can be transferred to another PETKIT PUROBOT ULTRA, which is only once a year. PETKIT Care+ service is a virtual commodity and is non-refundable once purchased.



[Click here to view the PETKIT Care+ Service Agreement.](#)

06 INSTRUCTIONS FOR CONTROL PANEL

6.1 Control Panel

① Press  to switch functions and press  to execute the function.

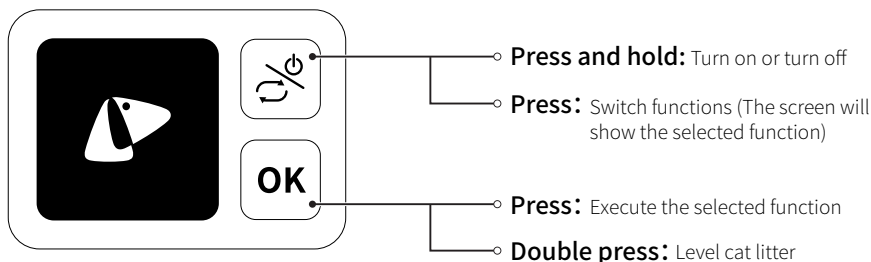

Description of Displayed Functions



Scoop

Automatically sift out clumps from cat litter.



Level cat litter

Make cat litter evenly distributed in the cylinder; Use it after refilling cat litter.



Pack

Automatically seal the trash bag.



Empty cat litter

Empty all cat litter from the cylinder.



Light

Turn on the fill light in the camera.



Connect to the network

Use it when binding the App.



Open / Close sealed door

Open or close the sealed door of the auto-packing module.



Reset

Adjust the cylinder to the correct position.

2 Description of displayed status

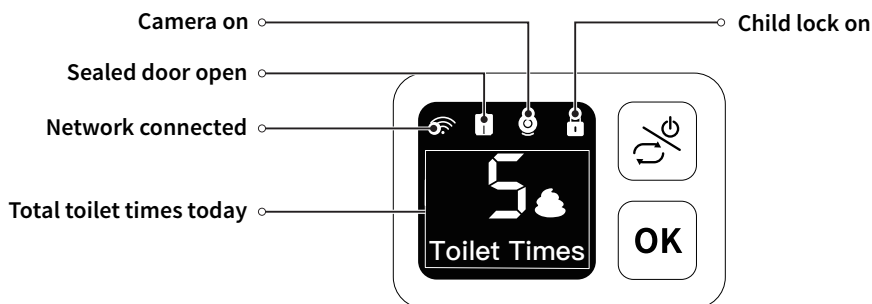

6.2 Auto-Packing

! The auto-packing function needs to be operated on the control panel. Do not leave the device during the packing process.

* When packing and refilling, the device will make a sound, which is normal and does not indicate any issues with the product's quality.

1 Press **U%** to select “Pack” and press **OK** , then double press **OK** as prompted on the screen, and the device will start packing.

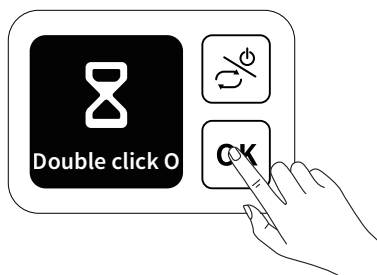
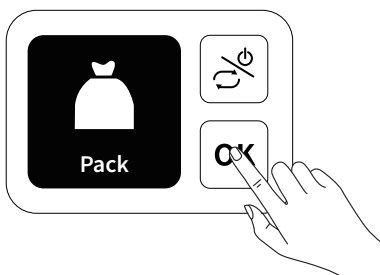

② After the screen shows the following icon and the device plays the prompt voice, open the lid, take out the packed trash bag, and close the lid.

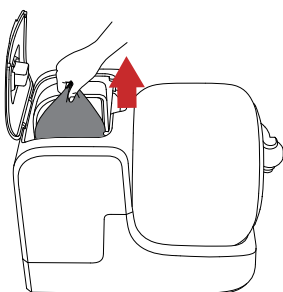

③ After removing the packed trash bag, please double press **OK** according to the screen and voice prompts to start auto-refilling.

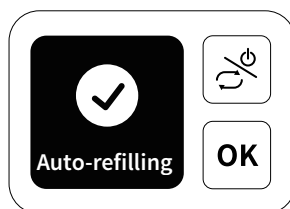

6.3 Empty Cat Litter

* Do not leave the device during the emptying process.

* After emptying all cat litter in the cylinder, you can replace the new cat litter or clean the device.

① Press **☰** to select "Empty cat litter", then press **OK**, and the device will automatically empty all cat litter in the cylinder.

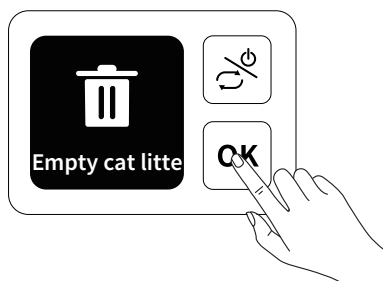

② If the waste bin is full during the emptying process, the device will stop emptying and start auto-packing. After packing, please take out the packed trash bag, and then double press **OK** to start auto-refilling.

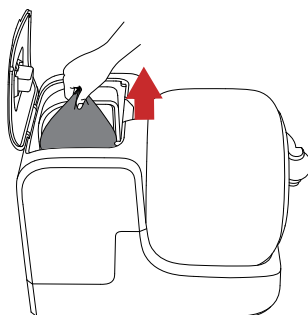

6.4 Description of other prompts

There will be scrolling text at the bottom of the screen.

Prompts	Description
 <p>Out of trash bag soon, please replace the refill ring in time</p>	<p>The trash bag is running out. Please prepare a new refill ring.</p>
 <p>Trash bag not refilled, please double click OK button to start auto-refilling</p>	<p>Waste bin is not bagged. Please double press OK button to start auto-refilling.</p>
 <p>Cat has approached</p>	<p>The cat approaches or enters the litter box during operation. (The device will automatically pause and alert, and it will resume after the pet leaves.)</p>
 <p>Out of trash bag, please replace the refill ring now</p>	<p>The trash bag has run out. Please replace a new refill ring.</p>
 <p>Trunk not installed</p>	<p>The trunk is not installed. Please check.</p>
 <p>Device failure</p>	<p>Device failure, please check the details in the App.</p>

07 CLEANING AND MAINTENANCE

For the cat's health, it is suggested to regularly clean or replace these parts.



Do not rinse or soak these parts: base, AI camera, and auto-packing module; otherwise, it may lead to device damage. Only wipe them.

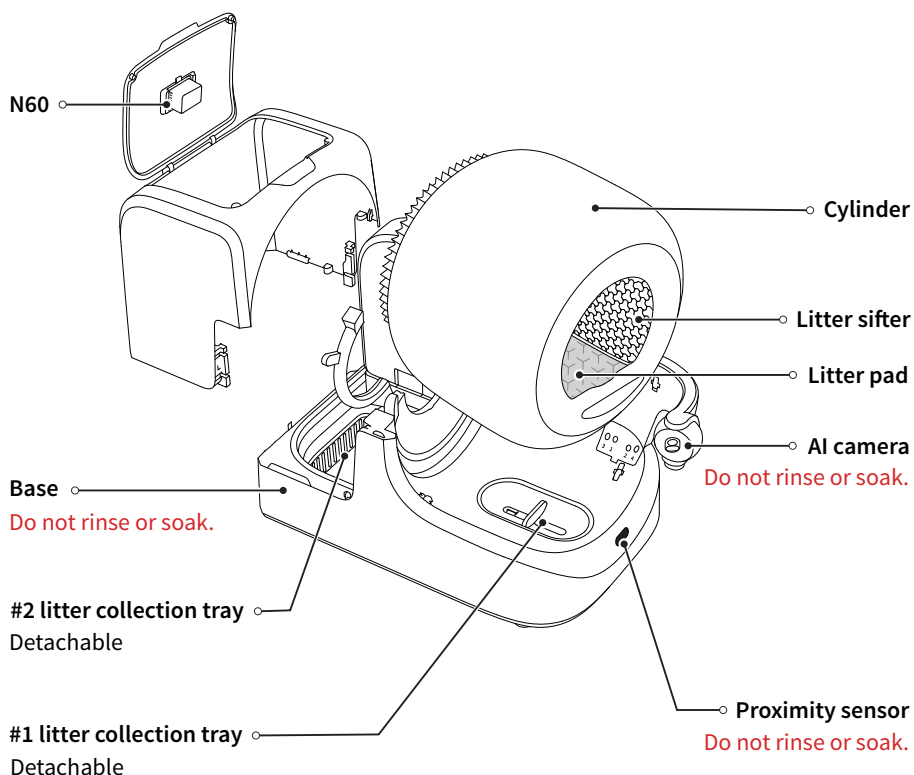

7.1 Detach Cylinder and Clean It

- * Before removing the cylinder, please empty all cat litter in it.
- * Before disassembly, please turn off the device or unplug it.

❶ Remove the trunk, unlock the buckle, and remove the cylinder.

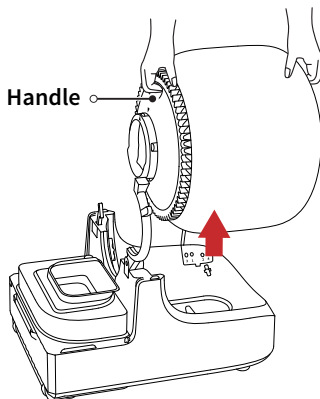
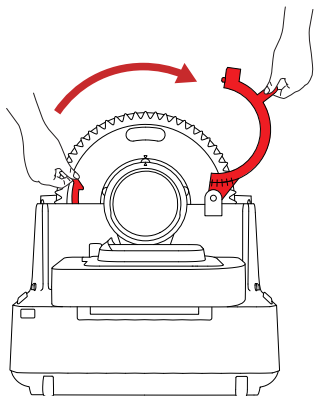

❷ Pinch the handle of the litter sifter to pull it out.

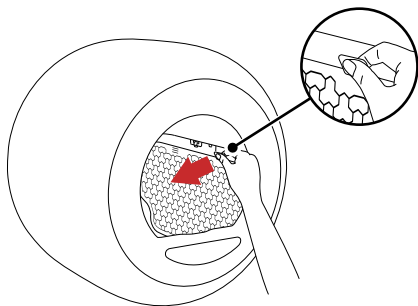

❸ Pinch the handle of the litter pad to pull it out.

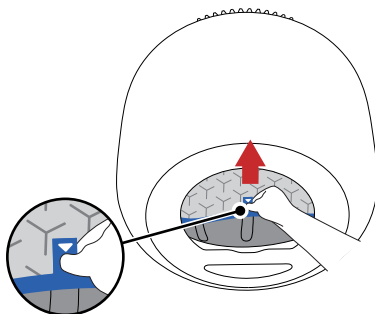

④ Clean the cylinder and the litter sifter with a brush, and rinse them. Wipe the litter pad with a soft cloth.

* Do not brush the litter pad violently to avoid damaging the coating. Do not clean with alcohol, disinfectant, bleach, non-neutral detergent, etc.

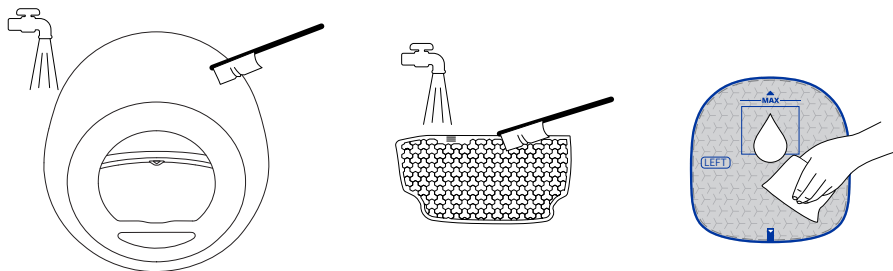



7.2 Install Components

⚠ Install components only when they are completely dry.

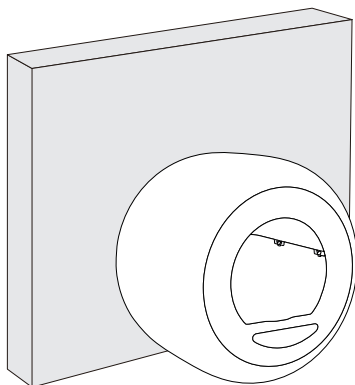
① Place the cylinder against the wall.



- ② Hold the litter pad, insert the top of it into the groove ( arrows need to be aligned), and then insert the bottom of it into the groove ( arrows need to be aligned).

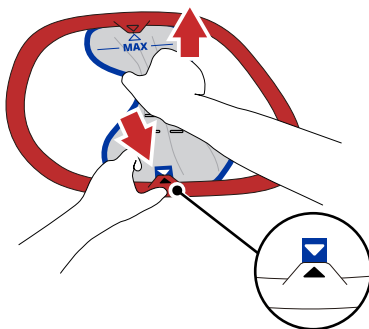
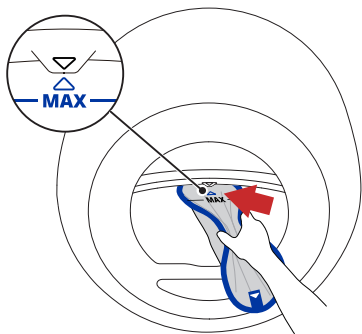

- ③ Gently press and release the pad, and the two sides of it will be naturally stuck into the groove.

* Before use, ensure that the blue edge is fully stuck into the groove and that the arrows on both ends are aligned with the indicated direction.

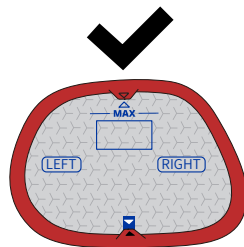
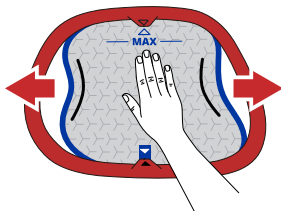
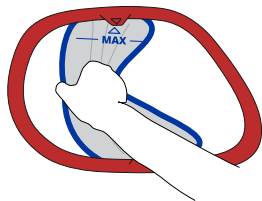

If the blue edge is not visible,
the installation is successful.

④ Pinch the handle of the litter sifter, first insert one buckle into point A, then insert the other buckle into point B.

*** Please check: If the litter sifter can swing back and forth, the installation is successful .**

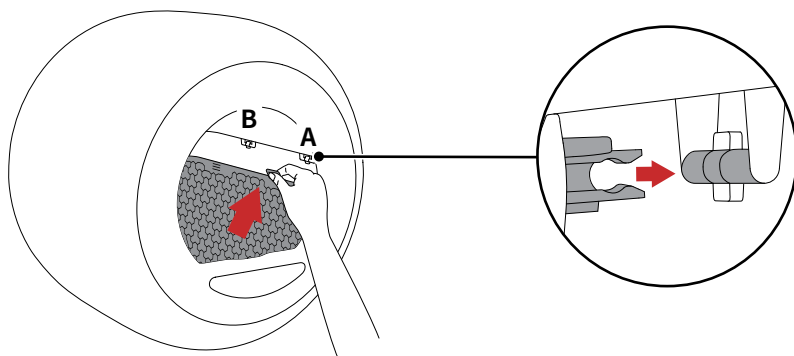

⑤ Put the cylinder on the base, lock the buckle, and make sure the buckle is fastened.

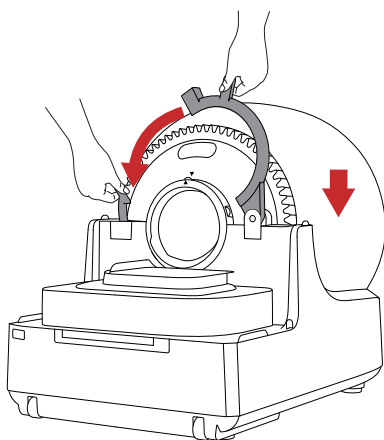

⑥ Install the trunk. The installation is complete.

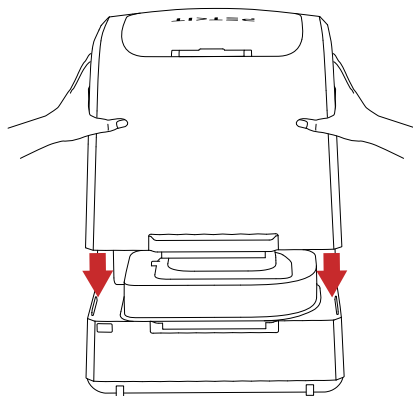

7.3 Maintenance of Other Components

- ❶ Wipe these components with a soft cloth: AI camera, base, and proximity sensor.

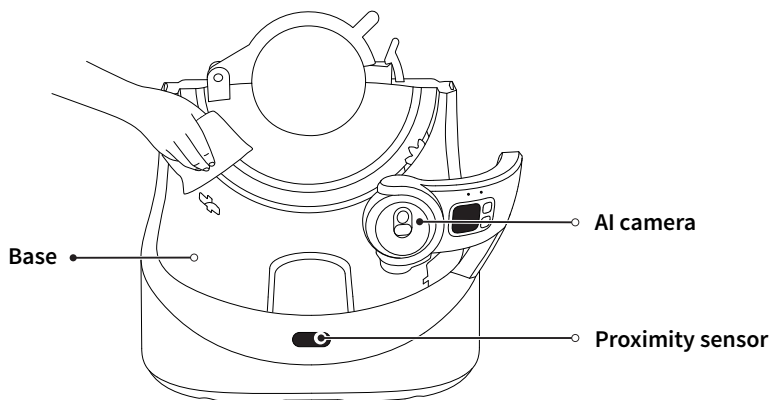

- ❷ If there is some litter in the #1 and #2 litter collection trays, take them out, dump the litter, and put them back.

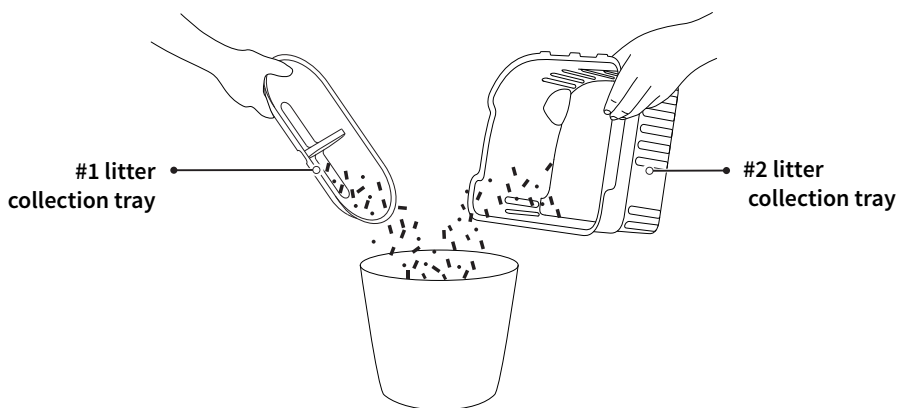

Components	When to Clean	How to Clean	When to Replace	How to Detach	Caution
AI Camera	Clean it when the lens is not clear.	Wipe with a soft cloth.	/	/	Do not rinse or soak.
Base	Clean it after removing the cylinder.	Wipe with a wet tissue.	/	/	Do not rinse or soak.
Cylinder	Clean it when the inner surface is dirty.	Clean with a brush.	/	See 7.1-①	/
Litter Sifter	Clean it when your pet has loose stools.	Clean with a brush.	Replace it when it is damaged or broken.	See 7.1-②	Avoid squeezing or exposure to sunlight.
Litter Pad	Clean it when it's dirty.	Wipe with a soft cloth. Do not scrub.	Replace it when it sticks to cat litter or is broken.	See 7.1-③	Do not clean with alcohol, disinfectant, bleach, non-neutral detergent, etc.
N60	/	/	About two months.	Slide upward.	/

08 VIDEO GUIDE

8.1 Video of Installation and Usage

Please copy the video URL and open it in your browser to view the video.

<https://usage.petkt.com/web-app/video-manual/product/video/list?deviceType=t6&language=en-US>

8.2 Video of Cleaning and Maintenance

Please copy the video URL and open it in your browser to view the video.

<https://usage.petkt.com/web-app/video-manual/product/video/list?deviceType=t6&language=en-US&selectedIndex=1>

09 TROUBLESHOOTING

Problems	Possible Causes	Solutions
Failed to Turn On	The plug may have been improperly inserted.	Reinsert the plug into the socket.
	The socket might be damaged or not powered on.	Ensure that the socket is powered on. Turn on the socket switch or replace the socket if necessary.
	The AI camera might have been incorrectly installed.	Power off, reinstall the AI camera, and securely tighten the four screws.
	A non-original power cable may have been used.	Always use the original power cable.
Cylinder Does Not Rotate	The device may not be bound to the app and activated.	Bind the app before first-time use. The device can operate only after successful binding.
	There might be a pet inside the device.	Check for pets inside. After the pet exits, double press the OK button to resume operation.
	Some components could have been improperly installed.	Power off, then ensure proper installation of the Refill Ring Cover, the Refill Ring, and the Trunk.
	The trash bag may be broken.	Power off, then ensure that the trash bag is removed and the waste bin is cleaned.
	The waste bin might be full.	Please pack in time.
	There could be an issue with the Refill Ring.	Replace with a new Refill Ring.
	Foreign objects could be obstructing the Cylinder gear.	<ol style="list-style-type: none"> 1 Power off, remove the Trunk and the Cylinder. 2 Check for foreign objects near the gear and clean them. 3 Reinstall the Cylinder and the Trunk, power on, then double press the OK button to resume operation.
Auto-Packing Failure	Some components may have been improperly installed.	Power off and reinstall the Refill Ring Cover and the Trunk properly.
	The trash bag might be used up.	Replace with a new Refill Ring.
	There could be a failure in the auto-packing module (including sealed door and slider).	<ol style="list-style-type: none"> 1 Power off, remove the Trunk. 2 Check for foreign objects near the sealed door and waste bin. 3 Clean up any foreign objects. 4 Manually put down the auto-packing module and install the Trunk. 5 Power on, then follow on-screen prompts to restart auto-packing by double pressing the OK button.
Auto-Refilling Failure	The waste bin might not be bagged.	<ol style="list-style-type: none"> 1 Power off and remove the Trunk. 2 Manually press the trash bag to the bottom. 3 Install the Trunk, power on, and double press the OK button to restart auto-refilling.
	The trash bag might be used up.	Replace with a new Refill Ring.
	There may be a failure in the auto-packing module.	<ol style="list-style-type: none"> 1 Power off, check the auto-packing module, then manually put it down. 2 Power on, then double press the OK button to restart auto-refilling.
	Some components might be improperly installed.	Power off, then ensure proper installation of the Refill Ring, the Refill Ring Cover, and the Trunk.

10 BASIC SPECIFICATIONS

Product Name	PETKIT PUROBOT ULTRA WITH CAMERA SELF-CLEANING CAT LITTER BOX
Product Model	P9903
Materials	ABS, PP, TPE, Silicone
Dimensions	532 x 818 x 612 mm (20.94 x 32.20 x 24.09 in)
Weight	about 14.6 kg (32.18 lbs)
Rated Input	12V === 4A
Connection	Wi-Fi
Range of Application	Cats older than 6 months

11 A MESSAGE TO OUR VALUED CUSTOMERS

- Thank you for choosing the PETKIT PUROBOT ULTRA WITH CAMERA SELF-CLEANING CAT LITTER BOX.
- Please read the user manual carefully before installing and using the product. Any installation or usage qindicates that you have read and accepted the safety guide below.
- PETKIT is not responsible for or legally liable for any accidents or injuries resulting from the improper use of the product.
- PETKIT reserves the right to interpretation and revision.

12 SAFETY INSTRUCTIONS

* Failure to follow the safety guides below may result in product malfunction or other unforeseen losses.

- Please install and use the device according to the user manual.
- Kittens younger than 6 months old are prohibited from using this device. Cats weighing less than 1.5 kg are prohibited from using this device.
- Do not drag the AI camera.
- Do not scratch the lens with sharp objects.
- Do not place the device in a high-temperature or high-humidity environment.
- The device is for indoor use only. Avoid direct sunlight exposure and keep it away from open flames.
- Although the device is powered by a low voltage, electric leakage may occur if the pet bites the power cord. Please keep your pets from biting the power cord.
- Please use only the original adapter to avoid device damage or safety hazards.
- Place the device on a firm, level surface, and avoid touching the wall.
- Do not tilt the device to avoid safety hazards.
- Do not rinse or soak the bottom of the device.
- There are weight sensors at the bottom of the device. Please handle it gently.
- Unplug it if the device is not used for an extended period.
- Children should use this device under the supervision and guidance of adults.
- Repairs should only be performed with professionals' guidance to avoid accidental damage.
- Do not place anything on top of the device or press the top of it.
- Before leaving for an extended period, please ensure that there is sufficient cat litter in the litter box and enough space in the waste bin.
- If you have any problems with the product, please contact our customer service for assistance.

Disposal

The European directive 2012 / 19 / CE on Waste Electrical and Electronic Equipment(WEEE), requires that old household electrical appliances must not be disposed in the normal unsorted municipal waste stream. Old appliances must be collected separately in order to optimize the recovery and recycling of the materials they contain and reduce the impact on human health and the environment. The crossed out "wheeled bin" symbol on the product reminds you of your obligation, that when you dispose of the appliance it must be separately collected. Consumers should contact their local authority or retailer for information concerning the correct disposal of their old appliance.

This device complies with part 15 of the FCC Rules. Operation is subject to the following two conditions:

- (1) This device may not cause harmful interference, and ;
- (2) this device must accept any interference received, including interference that may cause undesired operation.

FCC warning:

Any Changes or modifications not expressly approved by the party responsible for compliance could void the user's authority to operate the equipment. Note: This equipment has been tested and found to comply with the limits for a Class B digital device, pursuant to part 15 of the FCC Rules. These limits are designed to provide reasonable protection against harmful interference in a residential installation. This equipment generates uses and can radiate radio frequency energy and, if not installed and used in accordance with the instructions, may cause harmful interference to radio communications. However, there is no guarantee that interference will not occur in a particular installation. If this equipment does cause harmful interference to radio or television reception, which can be determined by turning the equipment off and on, the user is encouraged to try to correct the interference by one or more of the following measures:

- Reorient or relocate the receiving antenna.
- Increase the separation between the equipment and receiver.
- Connect the equipment into an outlet on a circuit different from that to which the receiver is connected.
- Consult the dealer or an experienced radio/TV technician for help.

The device has been evaluated to meet general RF exposure requirement.

This equipment complies with FCC radiation exposure limits set forth for an uncontrolled environment. This equipment should be installed and operated with minimum distance 20cm between the radiator & your body.

IC warning

- English:

This device complies with Industry Canada licence-exempt RSS standard(s). Operation is subject to the following two conditions:

- (1) This device may not cause interference, and
- (2) This device must accept any interference, including interference that may cause undesired operation of the device.

- French:

Le présent appareil est conforme aux CNR d'Industrie Canada applicables aux appareils radio exempts de licence.

L'exploitation est autorisée aux deux conditions suivantes:

- (1) l'appareil ne doit pas produire de brouillage, et
- (2) l'utilisateur de l'appareil doit accepter tout brouillage radioélectrique subi, même si le brouillage est susceptible d'en compromettre le fonctionnement.



PETKIT Network Technology(Shanghai)Co.,Ltd.
www.petkit.com
support@petkit.com